



SIRUI

伸缩式RGB LED管灯 T120 使用手册



前言

伸缩式RGB LED管灯T120，伸缩设计可变长度，有CCT、RGB、HSI模式、FX特效模式，可以调节对应参数数值获得相应光效。适用相机、手机、运动相机等设备，应用于人像、婚纱摄影、静物拍摄、产品摄影、直播、视频和微电影等场景。可以在有限空间内补光、轻松动感补光等。

主要特点

- 1、可伸缩设计，使用灵活，携带方便。
- 2、高亮度、高标准显色性能，带来更具质感画面。
- 3、超宽域色温，可模拟更多自然光源
- 4、智能控光，操作更简单。

包装清单

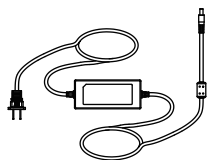

适配器 * 1

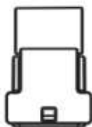

管夹 * 2

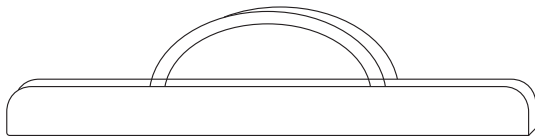

便携包*1



灯体* 1

产品介绍



1	伸缩位
2	DC接口
3	DMX转接口
4	电源开关
5	功能按键区
6	1/4螺丝安装孔

电源管理

1. 充电

使用前建议使用自带DC电源适配器充满电，充电时间约4h。充电时电源适配器显示红灯表示正在充电，显示绿灯表示充满。

（注：请使用配套适配器进行充电，其他规格有可能导致硬件损坏。如使用其他电源适配器造成的产品故障，不予保修）

2. 供电

内置锂电池，充满一次电100%亮度持续常亮约2.5h。也可以使用自带DC电源适配器连接电源使用，以获得灯光的长时间工作。

操作说明

1. 开关机

1.1、开关机

使用船型开关控制灯光电源打开和关闭。



2. 模式选择

短按M键选择CCT模式/HSI/RGB/FX特效模式。

在CCT/HSI/RGB模式下长按FN进入自定场景模式。

2.1 CCT模式



2.1.1 色温调节：按FN选中色温，按+ -键调节色温，最小变量100K，调节范围2700-8000K。

2.1.2 亮度调节：按FN选中色温，按+ -键调节亮度，最小变量1%，调节范围0-100%。

2.1.3 G/M值调整：按FN选中GM值调整，调节范围-50—+50。

2.2 FX情景特效模式

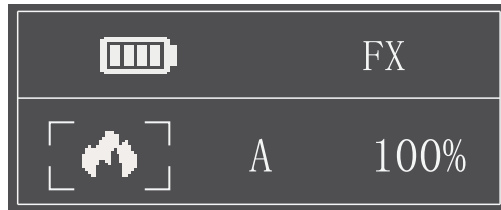

2.2.1 按FN选择灯光特效/速率/亮度，按+ -按键调整对应的值。

2.2.2 亮度调节，最小变量1%，调节范围0-100%。

2.2.3 情景特效模式有14类，用户可以根据需求选择：

序号	显示	场景	显示A	显示B	显示C
1		彩光循环	慢速	中速	快速
2		闪光灯	闪光	发布会	狗仔队
3		激光彩灯	生日会	KTV	迪斯科
4		雷闪电	间歇	频繁	持续
5		坏灯泡	间歇	频繁	持续
6		电视机	慢速	中速	快速
7		蜡烛	间歇	频繁	持续
8		火	柴火	篝火	火灾
9		烟花	短暂	连续	演出
10		警车	爆闪	频闪	快闪
11		消防车	爆闪	频闪	快闪
12		救护车	爆闪	频闪	快闪
13		音乐	音乐I	音乐II	
14	SOS	SOS			

2.3 HSI模式

按FN选择色相/饱和度/亮度，按+-按键调整对应的值。色相调节范围 0-359°，饱和度调节范围0-100。亮度调节最小变量1%，调节范围0-100%。



2.4 RGB模式

按FN选择R/G/B，按+-按键调整对应的值。调节范围0-255。

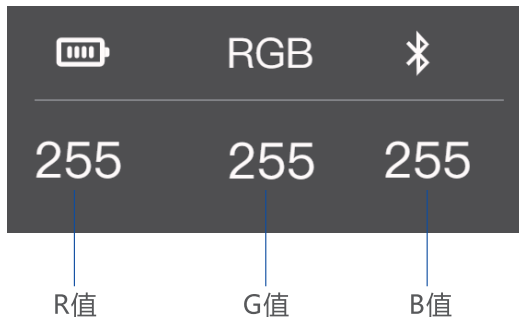

2.5 自定义模式

2.5.1 在CCT/HSI/RGB模式下长按FN进入自定义场景模式。

2.5.2 按F键选择读取/保存自定义场景；按+/-键选择自定义场景0-9的编号。

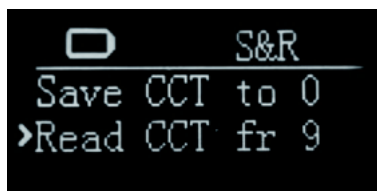

3. 连接手机APP

3.1. 长按M键打开蓝牙（再次长按SET关闭蓝牙）

3.2. 扫描二维码下载“SIRUI Light”手机APP

3.3. 手机打开蓝牙，在“SIRUI Light”APP中连接对应的灯就可通过APP控制灯。



扫码下载APP



* 具体操作请参考手机APP使用说明。

4. DMX控制

按M键选择DMX模式，将一台灯设置成LEAD模式，其余灯设置成从属模式FOLLOW，（最多连接15台灯），按FN按键选择ADD。按“+”或“-”按键设置ADD，可选择的ADD有512个(001~512)。

设置好ADD后用DMX连接线一端连接控制台DMX输出口，一端连接灯DMX输入（输入输出口需要另外购买转接线）。

运行模式 通道	CCT	HSI	RGB	FX
n	0-64	65-127	128-191	192-255
n+1	0-200 0-100% 亮度调节	0-200 0-100% 亮度调节	0-200 0-100% 亮度调节	0-200 0-100% 亮度调节
n+2	0-220 色温选择	0-180 H=180*2 色相选择	0-255 红光强度	0-252 14种特效分配
n+3		0-200 饱和度设置	0-255 绿光强度	0-85 速率A 86-171 速率B 172-255 速率C
n+3			0-255 蓝光强度	

5. 安装和固定

根据您的需要可以通过以下方式固定摄影灯。

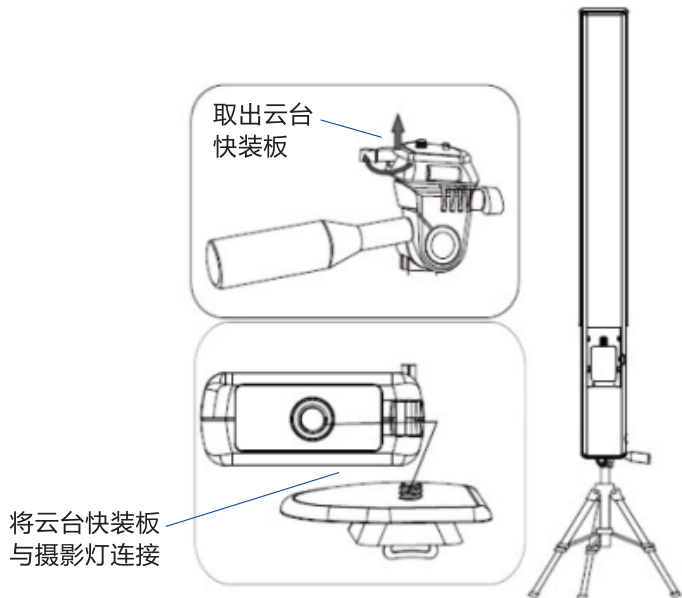

* 摄影灯直接固定在三脚架上使用

产品参数	
型号	T120
产品尺寸	51*50*1142mm/51*50*694mm
产品重量	约1242g
专用适配器	20V 3A
功率	最大40W
电池	2600mAh/14.4v/37.44Wh (双组)
色温范围	2500K~8000K
特效模式	14类
光照度	1m 700lux
TLCI	97
CRI	97
工作环境温度	-10°C-45°C
控制方式	手机APP
蓝牙无线控制距离	15m

* 设计和规格如有变更，恕不另行通知。

注意事项

- 1、产品应放置于凉爽、干燥、通风对的地方存储。
- 2、当灯具点亮时请勿长时间直视灯珠。
- 3、避免将灯具放置于易燃易挥发的溶剂附近。
- 4、避免在潮湿、多尘、过热的环境中使用。
- 5、请使用配套适配器，其他规格有可能导致硬件损坏。如使用其他电源适配器造成的产品故障，不予保修。

维护保养

- 灯体在工作时，如发现异常，应立即关掉电源，查明原因。
- 灯体应避免震动，平时注意表面除尘。
- 灯体稍有发热为正常现象。
- 维修由本厂维修部负责。
- 本产品保修一年，消耗品适配器、电源线等不在一年保修范围内，内置电池保修六个月。
- 经发现，擅自检修此灯的，将取消一年保修期，维修需要收取相关费用。
- 如果本品出现故障或者被水淋湿，在专业人员维修后方可继续使用。
- 设计和规格如有变更，恕不另行通知

警告

- 本产品不能防水，在雨天及潮湿环境下请注意防水。
- 请保持干燥，请勿用湿手接触产品，亦不可将产品浸入水中或暴露于雨中。
- 请勿在化学品、可燃性气体或其它特殊物质附件使用灯，有可能导致火灾或者电磁干扰。在这些场合下，请注意相关警告标示。
- 内置锂电池，禁止拆卸、撞击、挤压或投入火中，若出现严重鼓胀，请勿使用。
- 请勿放置在超过50°C的高温环境中，否则可能导致电池性能下降或损坏。使用产品要求参数的适配器进行充电，并且正确的按照操作说明，在规定的电压、温度范围内使用。
- 设备运行时请不要近距离直视灯光光线。



T120 Telescopic RGB Tube Light Instruction Manual



Foreword

The telescopic T120 RGB tube light can be freely stretched or retracted to your desired length. CCT mode, RGB mode, HSI mode, and FX mode are built into the light for many creative possibilities. This light is suitable for almost all shooting occasions, such as live streaming, portrait shooting, product shooting, weddings, short films, etc. It is portable and easy to operate with various control methods.

Features

1. The telescopic design provides flexible lengths. When fully retracted, the light is compact for storage.
2. High CRI/TLCI for vibrant natural light and accurate colors.
3. Wide color temperature range for seamlessly bending into ambient lighting situations.
4. Control by various methods.

What's in the Box

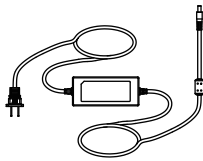

Adapter * 1

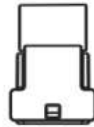

Clip * 2

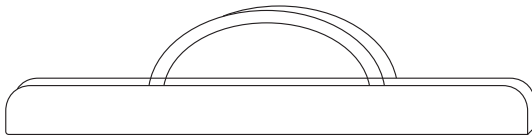

Carrying Bag*1



Light Body* 1

Name of Parts



1	Joint
2	DC Power Jack
3	DMX Port
4	Power Switch
5	Button Area
6	1/4" Screw Hole

Power Management

1. Power Supply

It is recommended to use the provided DC power adapter to fully charge the light (about 4 hrs) before use. The indicator is red while charging and turns green when charging is completed.

(Note: Please use the recommended adapter for charging. Use of unspecified power adapters may void the warranty).

2. Charge

There is a lithium battery in the tube light, which provides a 2.5-hour runtime at full power when fully charged. Connect the adapter to the power source for time-consuming work.

Operation

1. Power On/Off

1.1 Power Switch

Use the power switch to control the on or off of the RGB tube light.



2. Mode Selection

Hit the M button to choose from the CCT mode, FX mode, HSI mode, and RGB mode.

Press the FN button under the CCT/HSI/RGB mode to enter the Custom mode.

2.1 CCT Mode

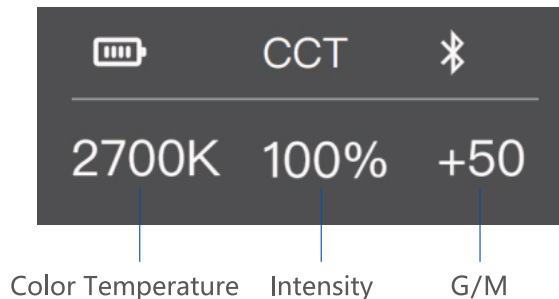

- 2.1.1 Color temperature adjustment: Hit the FN button to select the value. Press the +/- button to adjust the color temperature in at least 100K increments from 2700K to 8000K.
- 2.1.2 Intensity adjustment: Hit the FN button to select the value. Press the +/- button to adjust the intensity in at least 1% increments from 0% to 100%.
- 2.1.3 G/M adjustment: Hit the FN button to select the value, which is adjustable from -50 to +50.

2.2 FX Mode

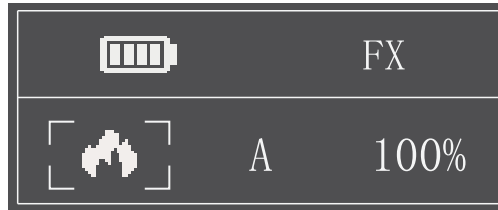

- 2.2.1 Hit the FN button to select Effect/Speed/Intensity, and press the +/- button to adjust the value.
- 2.2.2 Intensity adjustment: Press the +/- button to adjust the intensity in at least 1% increments from 0% to 100%.
- 2.2.3 There are 14 situational special effects for your choice:

No.	Display	Situation	Display I	Display II	Display III
1		RGB cycle	Slow speed	Medium speed	Quick speed
2		Flash	Flash	Press conference	Paparazzi
3		Party	Birthday party	KTV	Disco
4		Lightning	Discontinuous	Frequent	Sustainable
5		Broken bulb	Discontinuous	Frequent	Sustainable
6		TV	Slow speed	Medium speed	Quick speed
7		Candle	Discontinuous	Frequent	Sustainable
8		Fire	Firewood	Campfire	Fire hazard
9		Firework	Brief	Continuous	Show
10		Police car	Strong flash	Frequent flash	Quick flash
11		Fire truck	Strong flash	Frequent flash	Quick flash
12		Ambulance	Strong flash	Frequent flash	Quick flash
13		Music	Music I	Music II	
14		sos			

2.3 HSI Mode

Hue/Saturation/Intensity adjustment: Hit the FN button to select Hue/Saturation/Intensity. Press the +/- button to adjust Hue from 0° to 359°, Saturation from 0 to 100 and Intensity from 0% to 100%.

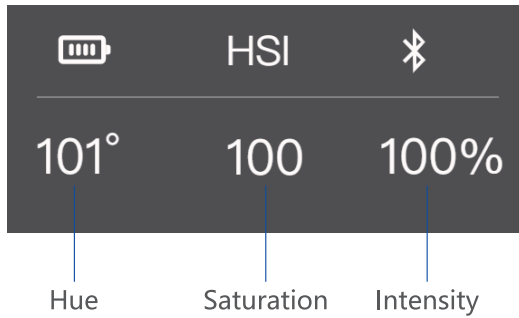

2.4 RGB Mode

Hit the FN button to select R/G/B. Press the +/- button to adjust R/G/B from 0 to 255.

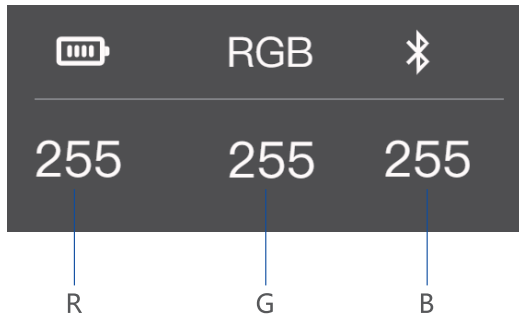

2.5 Custom Mode

2.5.1 Press the FN button under the CCT/HSI/RGB mode to enter the Custom mode.

2.5.2 Hit the FN button to Read/Save custom settings. Press the +/- button to select custom settings from 0 to 9.

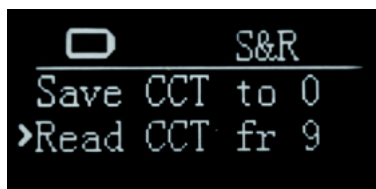

3. APP Control

- 3.1 Press and hold the M button to turn on Bluetooth. (Press and hold the M button again to turn off Bluetooth.)
- 3.2 Scan the QR code to download the "SIRUI Light" App.
- 3.3 Turn on Bluetooth on the phone and enter the "SIRUI Light" App. Select "T120 Tube Light" from the device list.



Scan the QR code to download the App



*For detailed steps, please refer to the APP instruction manual.

4. DMX Control Mode

Press the M button to select the DMX mode. Set one light to "LEAD" mode and the rest of lights to "FOLLOW" mode (supports up to 15 lights). Hit the FN button to select ADD, and press the +/- button to choose ADD from 001 to 512.

After setting ADD, connect one end of the DMX cable to the DMX output port of the controller and the other end to the DMX input port of the light.

Mode Channel	CCT	HSI	RGB	FX
n	0-64	65-127	128-191	192-255
n+1	0-200 0-100% Intensity Adjustment	0-200 0-100% Intensity Adjustment	0-200 0-100% Intensity Adjustment	0-200 0-100% Intensity Adjustment
n+2	0-220 CCT Selection	0-180 H=180*2 Hue Adjustment	0-255 Red Light Adjustment	0-252 14 Light Effects
n+3		0-200 Saturation Adjustment	0-255 Green Light Adjustment	0-85 Speed A 86-171 Speed B 172-255 Speed C
n+3			0-255 Blue Light Adjustment	

5. Setup

Set up the tube light as shown below.

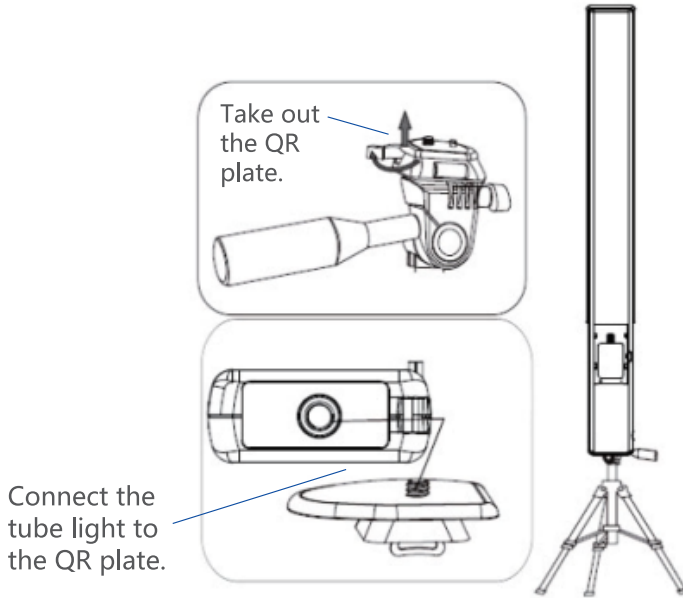

* Mount the tube light to the light stand.

Specifications	
Model	T120
Dimensions	51*50*1142mm/51*50*694mm
Weight	Approx. 1242g/2.74lbs
Adapter	20V 3A
Power	Max. 40W
Built-in Lithium Battery	2600mAh/14.4v/37.44Wh
Color Temperature Range	2500K~8000K
Special Effect	14
Illuminance	1m 700lux
TLCI	97
CRI	97
Operation Temperature	-10°C-45°C
Control Method	APP Control
Wireless Bluetooth Control Distance	15m

*Product design and specifications are subject to change without notice.

Cautions

1. The product should be kept in a cool, dry and ventilated place.
2. Do not look directly at the LED lamp beads when the light is on.
3. Do not put the light near flammable and volatile solvents.
4. Avoid using the light in humid, dusty, overheated environments.
5. Use of unauthorized power adapter may cause damage to the product and void the warranty.

Maintenance

1. If there is something wrong with the light when it is working, please turn it off first.
2. Avoid sudden impacts and the product should be dedusted regularly.
3. It is normal that the light gets a bit hot when it is working.
4. Maintenance must be performed by the authorized maintenance department which can provide original accessories.
5. This product, except for consumables, supports a one-year warranty.
6. Unauthorized service will void the warranty.
7. If the product had failures or was wetted, do not use it until it is repaired by professionals.
8. Changes made to the specifications or designs may not be reflected in this manual.

Warning

1. This equipment is not waterproof, please keep it dry and do not immerse it in water or other liquids.
2. The equipment should be installed in a dry and ventilated place, and avoid using it in rainy, humid, dusty or overheated environments.
3. Do not place the equipment near flammable and volatile solvents such as alcohol and gasoline.
4. This equipment has a built-in lithium battery. Please use the provided charger, and use it within a proper range of the specified voltage and temperature according to the correct operating instructions.
5. If the battery leaks, becomes discolored, deformed, emits smoke, or emits an abnormal odor, remove it immediately. Be careful during removal to avoid burns. Continued use could result in fire, electric shock, or burns. Do not use any deformed or modified batteries. Do not disassemble or modify this product or battery. Do not heat or solder the battery. Keep the battery away from fire or water. Do not incorrectly insert the positive and negative ends of batteries, or mix old and new batteries or batteries of different types together.
6. When the light is on, it is forbidden to look directly at the lamp beads under any circumstances.

产品保修

尊敬的用户，本保修卡是申请保修服务的重要凭证，请您配合销售商填写并妥善保管，谢谢！

产品信息	型号	产品条码
用户信息	姓名	联系电话
	通信地址	
销售商信息	名称	
	联系电话	
	通信地址	
	销售日期	
备注		

注：此表应由销售商盖章确认。

适用产品

本文件适用于相关《产品保修信息》(见后面说明)所列产品，其他非属此范围的产品或部件(如促销品、赠品及其他出厂后附加的部件等)不在此保修承诺内。

保修期

产品及部件的相应保修期按相关的《产品保修信息》执行。保修期自产品首次购买日起算，购买日以购买产品时保修卡登记日期为准。

如何获得保修服务

您可直接与产品销售商或授权服务机构联系，也可拨打思锐产品售后服务电话，与我们联系，由我们的服务人员为您安排服务。申请保修时，您应提供有效的保修卡作为保修凭证，方可获得保修。如您不能提供有效的保修卡，则在我们确认产品或部件属于保修池围的情况下，也可以为您提供保修，但这不作为我们的义务。

不适用保修的情况

如产品存在下列情况，本文件项下的保证和服务将不适用
①产品或部件超过相应保修期；②错误或不适当使用、维护或保管导致的故障或损坏，如：不当搬运；非按产品合理预期用途使用；不当插拔外接设备；跌落或外力挤压；接触或暴露于不适当温度、溶剂、酸碱、水浸或潮湿环境；③由非思锐授权机构或人员安装、修理、更改、添加或拆卸造成的故障或损坏；④产品或部件原有识别信息被修改变更或删除；⑤无有效保修卡；⑥使用非合法授权、非标准或非公开发行的软件造成的故障或损坏；⑦因不可抗力或意外事件造成的故障或损坏；⑧其他非因产品本身质量问题导致的故障或损坏。遇上述情况，您应向相关责任方寻求解决，思锐对此不承担任何责任。因非在保修期或保修范围内的部件、附件或软件导致产品不能正常使用的，不是保修范围内的故障。产品使用过程中正带的脱色，磨损和消耗，不是保修范围内的故障。

产品保修和服务支持信息

产品的保修期和服务类型按以下《产品保修信息》执行：

产品类型	保修期限
脚架、云台	6年
摄影灯	1年免费更换，质保2年
光学镜头	1年
防潮柜本体	6年（电子部分 3年）
配件	2年

广东思锐光学股份有限公司

地址：广东省中山市五桂山第三工业区

邮编：528458

电话：0760-88897373 传真：0760-88207062 服务热线：400 830 2299

邮箱：info@sirui-photo.com

网址：www.sirui.com

投诉电话：18165639388

(仅限工作日 8:15~12:15, 14:00~18:00)

Global Distributor Directory



Products Info



Official Website

News and Tutorials



YouTube

Services



Facebook

Thank you for purchasing SIRUI products! SIRUI will provide free warranty service if the product fails due to poor materials and workmanship under normal use.

The global agents are ranked in no particular order. If after-sales service is required, please contact the local agent first.

Headquarter of SIRUI Optical Co., Ltd.

After-Sale Service Hotline: 400 830 2299

Complaints Hotline: 181 6563 9388

Singapore/T K Foto Technic Pte Ltd

Address: Funan 107 North Bridge Rd #03-09 Singapore 179105

Tel: +65 6904 6610 **Fax:**+65 6904 6620

http: //www.tkfoto.com.sg **E-mail:** ark@tkfoto.com.sg

India/Foto centre Trading Pvt. Ltd

Address: Foto Centre Trading Pvt.Ltd* 303, 3rd Floor, Ravi Building, 189-191, Dr. D. N. Road, Mumbai-400 001.Maharashtra,India **Tel:** 0091-9820110120

http: //www.sirui.in **E-mail:** info@sirui.in

Canada/LightPro Group Inc

Address: 3206 Wharton Way Mississauga, ON L4X 2C1

Toll Free: 1-800-361-9682 **Tel:** 905-940-9262

http: //www.lightprogroup.com **E-mail:** Sales@lightprogroup.com

Kazakhstan/PSP Digital

Address: г. Алматы, проспект Абая 130 (территория ЖК «Абая 130»)

Tel: 8 707 217 03 99 8 707 958 54 94

http: //pspdf.kz/contacts **E-mail:** pspkz@mail.ru

Russia /REQUIRED, LLC

Address:

Tel: 8 (499) 500-96-27

http: //kremlinstore.ru **E-mail:** order@kremlinstore.ru

Romania/West Buy S.R.L

Address: Bdul. Mircea Voda nr. 36, Sector 3, Bucharest, Romania, 030688
Telephone: +(4)021.3205652 **Tel/Fax:** +(4)021.3205655 **Mobile:** +(4)0745414956
Mobile: +(4)0752111704 **Mobile:** +(4)0756111947 **Mobile:** +(4)0752110439
http: //www.westbuy.ro **E-mail:** westbuy1@gmail.com

Slovenia/Infocona d.o.o

Address: Prevale 9, 1236 Trzin
Tel: 01/ 562 00 61 **http:** // **E-mail:** info@infocona.si

Turkey/siruiturkiye

Address: Çobançesme Mah. Sanayi Cad. Kımız Sk. No:12 Yenibosna Bahçelievler, İstanbul
Tel: 0(850)222 37 73
http: //www.siruiturkiye.com **E-mail:** oceltikci@essegrup.com

Hong Kong/HONG KONG RUIJIE TRADING COMPANY LIMITED

Address: UNIT C 15/F HUA CHIAO COMM CTR 678 NATHAN RD MONGKOK KL
Tel: 00852-9409 5241
http: // **E-mail:** paulli34@foxmail.com

South Africa/Sunshine Distribution PTY LTD

Address: 29 Keyes Avenue, Rosebank Johannesburg, 2196, South Africa
Mobile: +27 79 641 0288 **Phone:** +27 11 268 0803
http: //www.sunshineco.co.za **E-mail:** Willem@sunshineco.co.za

Israel/Argol LTD

Address: 19 Hamerkava st.Holon 5885113 Israel
Tel: +972-3-5581901-6 **Fax:** +972-3-5501148
http: //www.argol.co.il **E-mail:** eli@argol.co.il

Malaysia/Leomax (M) Sdn Bhd

Address: B-5-7, block B, Pusan komersial southgate Jln dua, off jln Chan sow Lin 55200 Kuala Lumpur, Malaysia **Tel:** (+603)9224 2001
http: //www.leomax.com.my **E-mail:** account@leomax.com.my

Panama /TODO FOTO PANAMA

Address: Avenida Justo Arosemena y Cl. 45 Este, Panamá Ciudad de Panamá
Tel: 225-4620 / 203-1288
http: //www.todofotopanama.com **E-mail:** rosa@todofotopanama.com

Nigeria/Nextgen Media Ltd

Address: 73, Allen Avenue, Ikeja, Lagos
M. +234 (0) 805 1987 394 | +234 (0) 909 1094 565
http: //www.nextgentv.tv **E-mail:** Afolasade.OK@nextgentv.tv

Ukraine/BIGggSALE.com

Address: Ровно: ул. Данила Галицького 19, 718 офіс. (Главный офіс)
Tel: (096)308-36-00;(063)308-36-00;(066)308-36-00
http: //BIGggSALE.com **E-mail:** shop@biggg-sale.com

Luxembourg / Benel BV

Address: Buitenvaart 1127A, Hoogeveen, 7905 SE, The Netherlands,
Tel: +31 528 234 828
http: // www.siruishop.nl **E-mail:** info@siruishop.nl

Belgium/ Benel BV

Address: Buitenvaart 1127A, Hoogeveen, 7905 SE, The Netherlands,
Tel: +31 528 234 828
http: // www.siruishop.nl **E-mail:** info@siruishop.nl

Italy /TOSCANA FOTO SERVICE S.r.l.

Address: Via Ponte all' Asse, 2/4, 50019 Sesto Fiorentino (FI)
Tel:
http: //www.sirui-italia.it **E-mail:** info@fotocomm.it

Poland/Focus Nordic

Address: Al. Jerozolimskie 180, 02-486 Warszawa
Tel: +48 697 991 248
http: //www.focusnordic.pl **E-mail:** info@focusnordic.pl

Taiwan/Tai Nein Company Ltd.

Address: 2F, No.29, Ren Ai Road, Sec 2, Taipei, Taiwan

Tel: +886-2-33433966 **Fax:**+886-2-33433969

http: //www.lf99.com **E-mail:** tainein@ms23.hinet.net

Thailand/ 456 Marketing Company Ltd

Address: 636/12 Soi Ramkhamhaeng 39 (Thepleela1), Wangthonglang, Bangkok 10310, Thailand. **Tel:** (+662)934-6565

http: //www.456mkt.com **E-mail:** online@456mkt.com

Kenya/Cameras Africa

Address: Nairobi along Kenyatta Avenue, next to Phoenix House. 1 Min Walk from Sentrim 680 Hotel

Tel: 00254722764900

http: //www.camerasafrica.com **E-mail:** sales@camerasafrica.com

New Zealand/Photogear

Address: (1) 3/2 Tawa Drive, Rosedale, Auckland (2) 49 Mackelvie Street, Ponsonby, Auckland

Tel: (+64) 9 4792886

http: //www.photogear.co.nz **E-mail:** support@photogear.co.nz

Slovakia/Focus Nordic AB

Address: KUTA centrum, Zelený pruh 95/97, 140 00 Praha 4, Česká Republika

Tel: +420 604 582 550

http: //www.focusnordic.sk **E-mail:** info@focusnordic.sk

Czech Republic/Focus Nordic

Address: Zeleny pruh 95/97, 140 00 Praha 4

Tel: +46 31 336 23 00

http: //www.focusnordic.cz **E-mail:** info@focusnordic.cz

Netherlands/ Benel BV

Address: Buitenvaart 1127A, Hoogeveen, 7905 SE, The Netherlands,

Tel: +31 528 234 828

http: // www.siruishop.nl **E-mail:** info@siruishop.nl

Estonia/Focus Nordic

Address:

Tel: +46 31 336 23 00

http: //www.focusnordic.ee **E-mail:** info@focusnordic.ee

Vietnam (Hanoi)/SÔNG HỒNG CAMERA

Address: SÔNG HỒNG CAMERA - 44 TRĂNG THI, HOÀN KIẾM, HÀ NỘI

Tel: Hotline CH: 098.888.2533 - 024.3938.2267

http: //www.songhongcamera.com **E-mail:** banhang@songhongcamera.com

Vietnam (Ho Chi Minh)/Rawshop.vn

Address: 61 Đường Núi Thành, Phường 13, Tân Bình, Thành phố Hồ Chí Minh, Vietnam

Tel: 00842862656999

http: //rawshop.vn **E-mail:** thanhnam79@gmail.com

Saudi Arabia/Cameramix

Address: Al-Manar, Jeddah 23462 Saudi Arabia **Al-Manar, Jeddah 23462 Saudi Arabia**

Tel: 00966126282444

http: //cameramix.com **E-mail:** sales@cameramix.com

Republic of Korea/ Daekwang Enterprise

Address: Namdaemunno 10, Jung-gu, Seoul, South Korea (zip: 04528)

Tel: (+82) 2-752-3304

http: //www.sirui.co.kr **E-mail:** daekwangas@gmail.com

Australia/ DISCOUNT DIGITAL PTY LTD

Address: Suite1,64 Alexander St, crows Nest NSW2065, Australia

Tel: (+61)408 660 083

http: //www.pixelone.com.au **E-mail:** sales@pixelone.com.au

Indonesia/ Focus Nusantara

Address: Jln.Tanah Abang II No 77 Jakarta Pusat -10160, Indonesia

Tel: (+62)21 380 8080

http: //focusnusantara.com **E-mail:** saiful@focusnusantara.com

Republic of Lithuania /Focus Nordic

Address: Vienibas Avenue 109, LV-1058 Riga Latvia

Tel: +37 06 12 86 120

http: //www.focusnordic.lt **E-mail:** info@focusnordic.lt

Sweden/Focus Nordic AB

Address: Bergsjödalen 48, 41568 Gothenburg

Tel: +46 31 336 23 00

http: //www.focusnordic.com **E-mail:** info@focusnordic.se

Norway/Focus Nordic

Address: Ringeriksveien 164, 1339 Vøyenenga

Tel: +47 67 17 37 00

http: //www.focusnordic.no **E-mail:** info@focusnordic.no

Finland/Focus Nordic

Address: Knitter Business Park, Kutojantie 6-8, FI-02630 Espoo

Tel: +35 89 42 83 41 01

http: //www.focusnordic.fi **E-mail:** info@focusnordic.fi

Denmark/Focus Nordic

Address: Erhvervsvej 30, DK-2610 Rodovre

Tel: +46 31 336 23 00

http: //www.focusnordic.dk **E-mail:** info@focusnordic.dk

Iceland/Focus Nordic

Address:

Tel: +46 31 336 23 00

http: //www.focusnordic.is **E-mail:** info@focusnordic.is

Latvia /Focus Nordic

Address: Vienibas Avenue 109, LV-1058 Riga Latvia

Tel: +46 31 336 23 00

http: //www.focusnordic.lv **E-mail:** info@focusnordic.lv

Sri Lanka/CameraLK Store

Address: CameraLK Colombo: 263, Highlevel Road Colombo 05 00500 - Western

CameraLK Majestic City: No 28, 3rd Floor Majestic City Colombo 04 00400 - Western

CameraLK Kandy: 127A 1/1 D S Senanayake Veediya Kandy 20000 - Central Province
0812233872

Tel: +(94) 117 817 870

http: //www.cameralk.com **E-mail:** ushitha@cameralk.com



Garantie
Warranty
Garantía
Garanzia



SIRUI Professional Photographic Equipment

Category	Warranty Period	Kategorie	Garantiezeit
Tripods, Heads	6 Years	Stative, Stativköpfe	6 Jahre
Lighting Products	2 Years (Free replacement for one year)	Beleuchtungsprodukte	2 Jahre (kostenloser Ersatz für 1 Jahr)
Optical Lenses	1 Year	Objektivprodukte	1 Jahr
Humidity Control Cabinets	6 Years (Electronic components: 3 years)	Humidor-Schränke	6 Jahre (3 Jahre auf elektronische Teile)
Accessories	2 Years	Zubehör	2 Jahre

Model, Modell, Modèle, Modelo

Date, Datum, Fecha, Data

Dealer, Händler, Marchand, Comerciante, Negociante

European Service Center:

SIRUI Optical GmbH • Ernst-Augustin-Str. 1a • 12489 Berlin • Germany

Phone: +49 30 991 94 94 00

Email Address : info@siruioptical.eu

Deutsch

Die SIRUI Optical GmbH, Ernst-Augustin-Str. 1a, 12489 Berlin, gewährt Käufern eine Garantie von 6 Jahren ab Kaufdatum auf die Freiheit von Herstellungs- und Materialfehlern dieses Produkts. Von dieser Garantie nicht erfasst sind Schäden durch mechanische Beeinträchtigungen, große Hitze, nicht bestimmungsgemäße Verwendung sowie Abhandenkommen. Diese Garantie gilt nur in Verbindung mit dieser Garantiekarte und einem in Europa ausgestellten Kaufbeleg. Die gesetzlichen Rechte – insbesondere die gesetzlichen Gewährleistungsrechte – bleiben hiervon unberührt. Im Garantiefall wenden Sie sich bitte an das umseitig genannte Servicecenter.

English

SIRUI Optical GmbH, Ernst-Augustin-Str. 1a, 12489 Berlin, guarantees purchasers that this product will remain free from manufacturing and workmanship defects for 6 years from the date of purchase. Damage caused by mechanical damage, excessive heat, improper use and loss are not covered by this warranty. This warranty is valid only in connection with this warranty card and a receipt issued in Europe. Statutory rights – in particular the statutory warranty rights – remain unaffected. In the event of a warranty claim please contact the service centre listed overleaf.

Français

La société SIRUI Optical GmbH, Ernst-Augustin-Str. 1a, 12489 Berlin, Allemagne, offre aux acheteurs une garantie de 6 ans, à compter de la date d'achat, contre tous défauts de fabrication ou de matériaux. Cette garantie ne couvre pas les dommages causés par des problèmes mécaniques, la chaleur excessive, l'utilisation abusive et la perte. La garantie est uniquement valable si associée à la présente carte de garantie et une preuve d'achat délivrée en Europe. Les droits légaux – en particulier les droits de garantie prévus par la loi – restent inchangés. En cas de recours à la garantie, veuillez vous adresser au centre de service mentionné au recto.

Italiano

La SIRUI Optical GmbH, Ernst-Augustin-Str. 1a, 12489 Berlin, offre agli acquirenti una garanzia di esenzione da difetti di fabbrica e di lavorazione di questo prodotto, della durata 6 anni dalla data di acquisto. Tale garanzia non copre alcun danno causato da guasto meccanico, calore eccessivo, uso improprio nonché perdita. La garanzia è valida solo se accompagnata dalla presente scheda di garanzia e ad una prova di acquisto rilasciata in Europa. I diritti legali - in particolare, i diritti di garanzia previsti dalla legge - rimangono inalterati. In caso di intervento in garanzia, si raccomanda di rivolgersi al centro di assistenza indicato sul retro.

Español

La sociedad SIRUI Optical GmbH, Ernst-Augustin-Str. 1a, 12489 Berlin, otorga a sus compradores una garantía de 6 años a partir de la fecha de compra por los vicios ocultos y defectos de fabricación de este producto. La garantía no cubrirá los daños ocasionados por desgastes mecánicos, altas temperaturas, un uso no conforme con lo prescrito o por pérdida o extravío, y sólo será válida presentando esta carta de garantía y el comprobante de compra expedido en Europa. Lo anterior no afectará a los derechos legales y, en particular, a los derechos de garantía legales. En el caso contemplado en la garantía, le rogamos se ponga en contacto con el Centro de atención al cliente, cuya dirección consta en el dorso de esta carta de garantía.

Portugués

A SIRUI Optical GmbH, Ernst-Augustin-Str. 1a, 12489 Berlin, garante aos seus clientes uma garantia de 6 anos a partir da data de aquisição relativa à liberdade de defeitos de produção e fabrico do produto. Esta garantia não cobre danos causados por efeitos adversos decorrentes de avaria mecânica, calor excessivo, utilização indevida, ou perda. Esta garantia é apenas válida mediante apresentação deste cartão de garantia e um recibo emitido na Europa, sem prejuízo dos direitos legais (em particular, os direitos legais de garantia). Em caso de reclamação, contate o centro de serviço referido no verso.

SIRUI Warranty

Professional Photographic Equipment



Thank you for your purchase of Sirui professional products! Sirui warrants that your purchase is free from defects in materials and workmanship, under normal use during the Limited Warranty period. The warranty period starts on the original date of purchase on your sales receipt. If service is required, please include a copy of the sales receipt and this warranty card, with an explanation of the problem. Please store your sales receipt and warranty card in a safe location.

Category	Warranty Period
Tripods, Heads	6 Years
Lighting Products	2 Years (Free replacement for one year)
Optical Lenses	1 Year
Humidity Control Cabinets	6 Years (Electronic components: 3 years)
Accessories	2 Years

Model purchased : _____

Date : _____

Store : _____

Serial number : _____

Sirui USA Limited Warranty

This warranty is limited to the repair, adjustment and/or replacement, at Sirui or its authorized distributor's option, of defective parts, free of charge (except the cost of transportation to the distributor/service center). Responsibility is limited to actual cost of item.

Register online at www.sirui.com. Call or email with questions or problems, before sending product in for repair. For warranty service on product purchased in the USA, all shipping and insurance charges must be prepaid. Include a copy of the sales receipt, this warranty card and an explanation of the problem. The product or defective part(s) may be sent through a local authorized SIRUI USA dealer or directly to the SIRUI USA distributor/service center indicated on this warranty card. Sirui will not be responsible for expenses or inconveniences, or consequential damages to equipment, or by breach of any expressed or implied warranty.

Out-of-warranty repairs - An estimate (including shipping costs) will be provided by the SIRUI USA distributor/service center indicated on this warranty card and repairs will begin once the estimate is approved and payment is received. A return shipping fee will be charged for refused estimates.

Limitations

Warranty is non-transferable. This warranty covers all defects encountered in normal use of the equipment and does not apply in the following cases:

- 1) If the equipment has been serviced by other than an authorized Sirui distributor or service center.
- 2) Damage to the equipment due to modification, overloading, mishandling, abuse, accident, sand, corrosives, water damage or not following operating instructions.
- 3) No valid proof of purchase is provided.
- 4) Damage caused by acts of nature (including, but, not limited to fires, floods or earthquakes).

This warranty is only valid when product is purchased from an authorized SIRUI USA dealer.

Please visit SIRUI's USA official website or consult the local dealer for the Return and Exchange Policy.



SIRUI USA, LLC

For technical support, service or repairs please contact:

29 Commerce Court Verona, NJ 07044

info@sirui.com Phone: 866-373-0829



SIRUI Light APP User Guide



Contents

I、APP Description

1.1 Overview	01
1.2 App Download and Installation	01
1.3 Splash Screen	02
1.4 Studio	02
1.5 Light Control Interface	05

II、Main Features

2.1 CCT Mode	06
2.2 Colorful Mode	07
2.3 Custom Mode	08
2.4 Effects Mode	09
2.5 Color Picker	10

III、Group Control

IV、Firmware Upgrade

4.1 Bluetooth Firmware Upgrade	12
4.2 Main Firmware Upgrade	13

I .APP Description

1.1 Overview

SIRUI Light APP is designed for SIRUI LED light series. This app allows you to adjust various parameters (color temperature, brightness, hue, saturation, etc.) as required to add more creativity to your scenes.

1.2 App Download and Installation

Please scan the QR code below or search for "SIRUI Light" in the App Store to download the App (iOS 9.0/Android 5.0 or above)



Scan to download



Notice:

Before using the App, please turn on Bluetooth, GPS location and allow the App to access storage and camera.



1.3 Notice

L2 is a Bi-color and RGB LED Light. The following operations take L2 LED light as an example. SIRUI has both single-color and Bi-color LED lights. The APP instruction of these lights is quite similar.

1.3 Splash Screen

The splash screen below will appear when clicking on the icon of SIRUI Light APP. The splash screen will display the product and the preview will last for about 2 seconds.

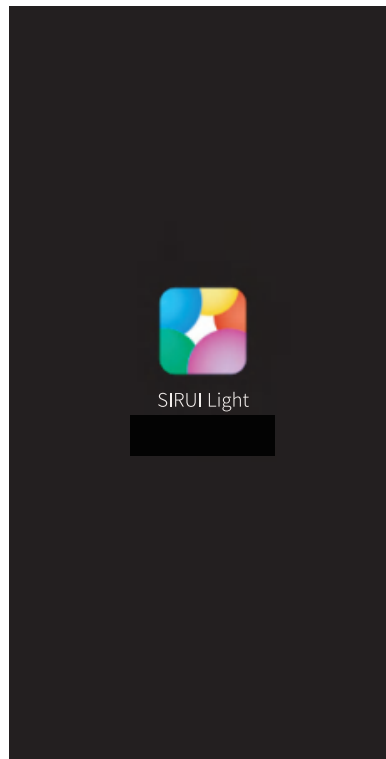

1.4 Studio

After entering the studio, the App will automatically search for lights that are turned on. Select the lights you want and start combination.

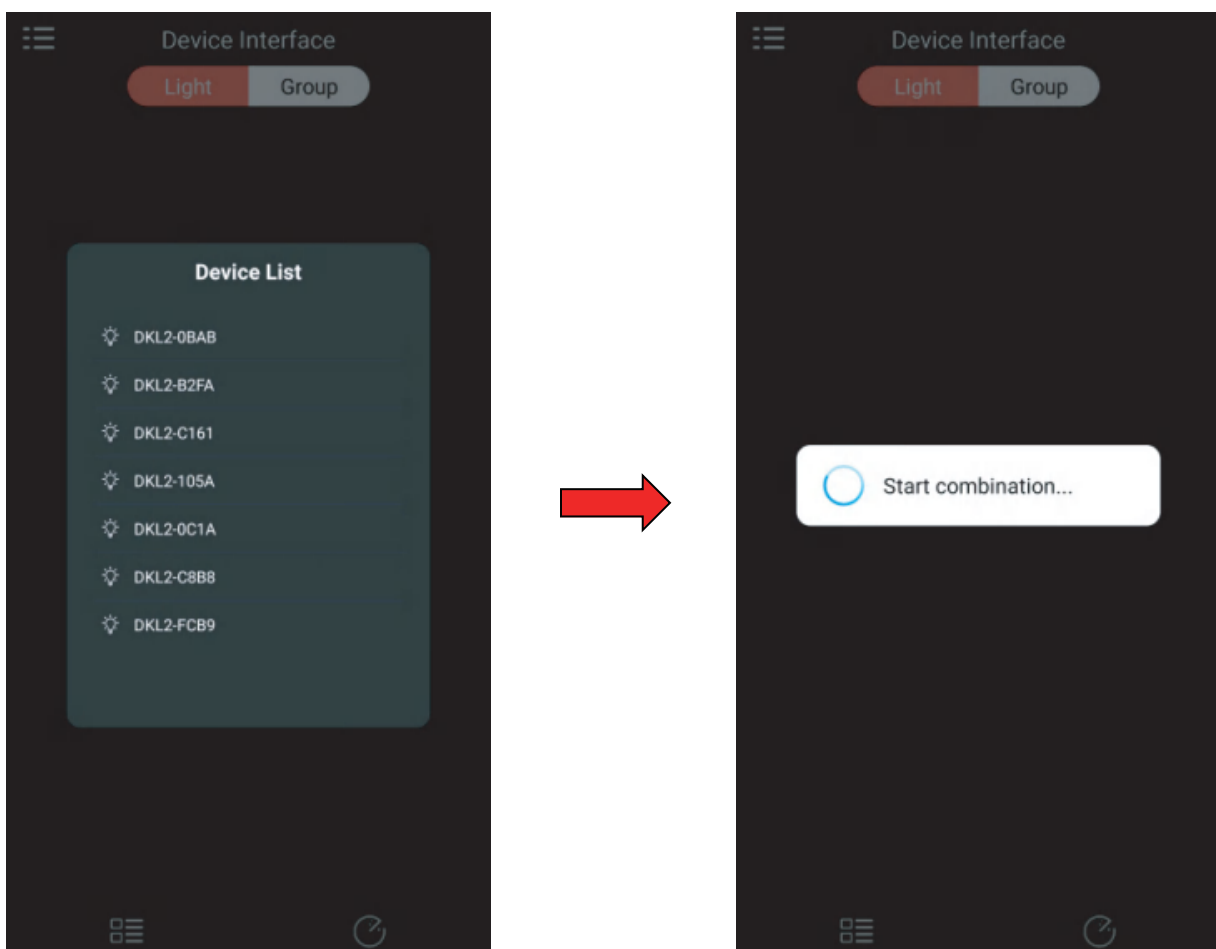

Once the combination is finished, lights will be listed in the studio. You can rename/turn on or off the lights, check their battery level or upgrade their firmware all in this app.

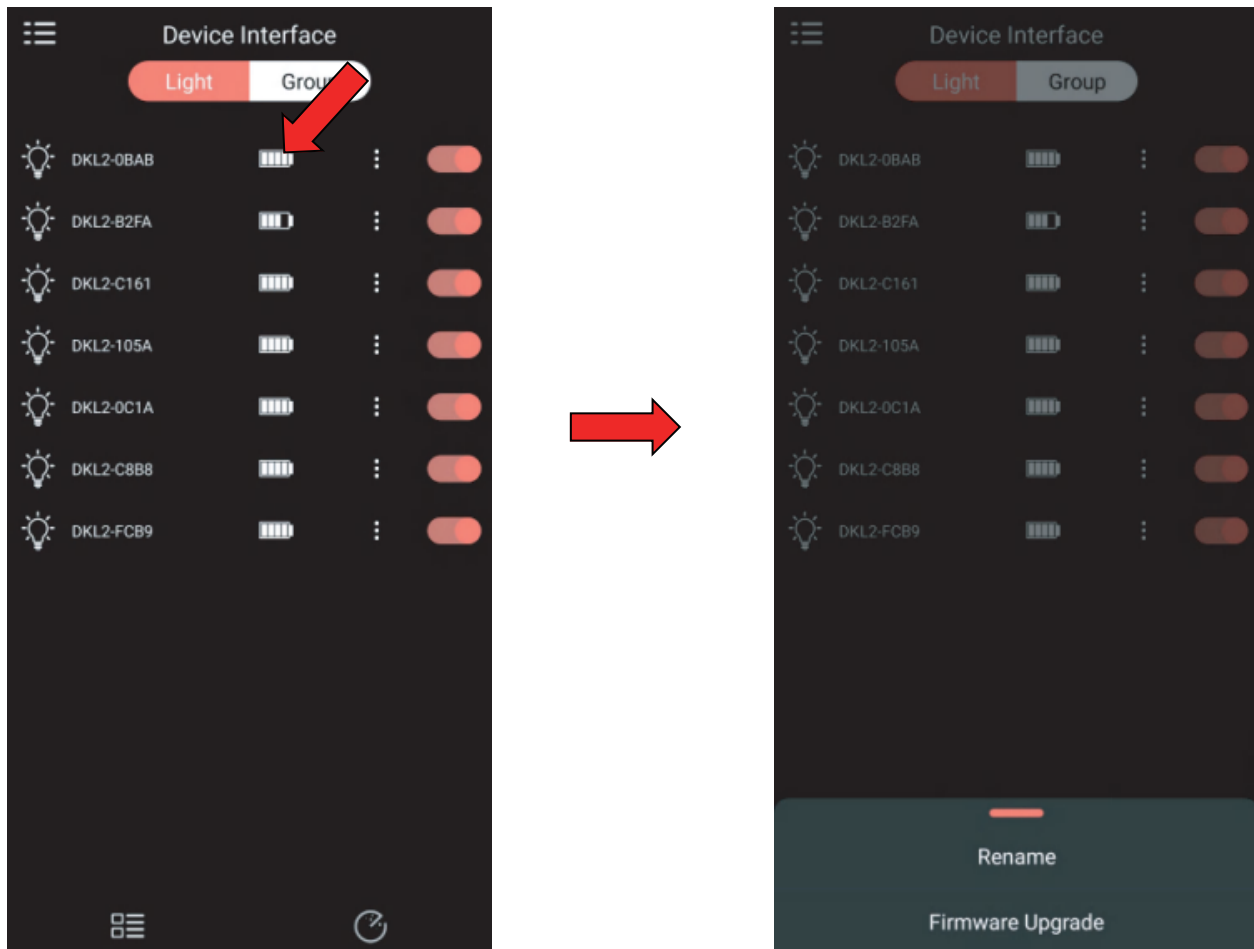

Click the button on the upper left to enter the information interface, where you can select a language, view the Privacy Policy, User Agreement, APP version number and check whether there is a new version for the APP.

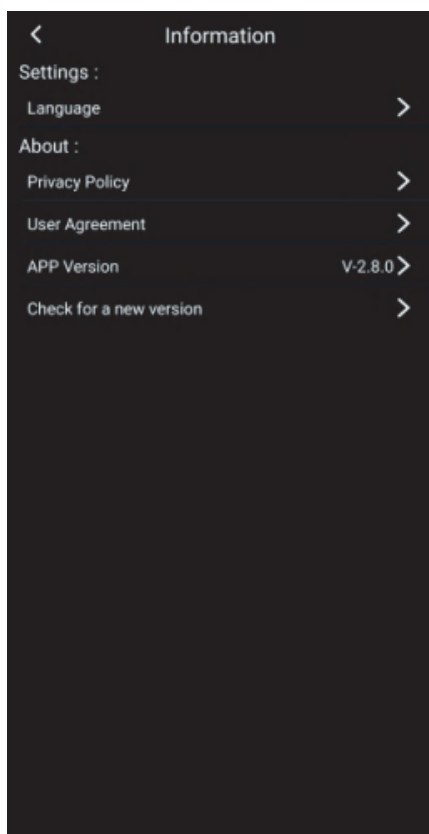

Click the "more" button on the lower right to view the product manual.



User Guide

T120



1.5 Light Control Interface

Click a light to enter its control interface.

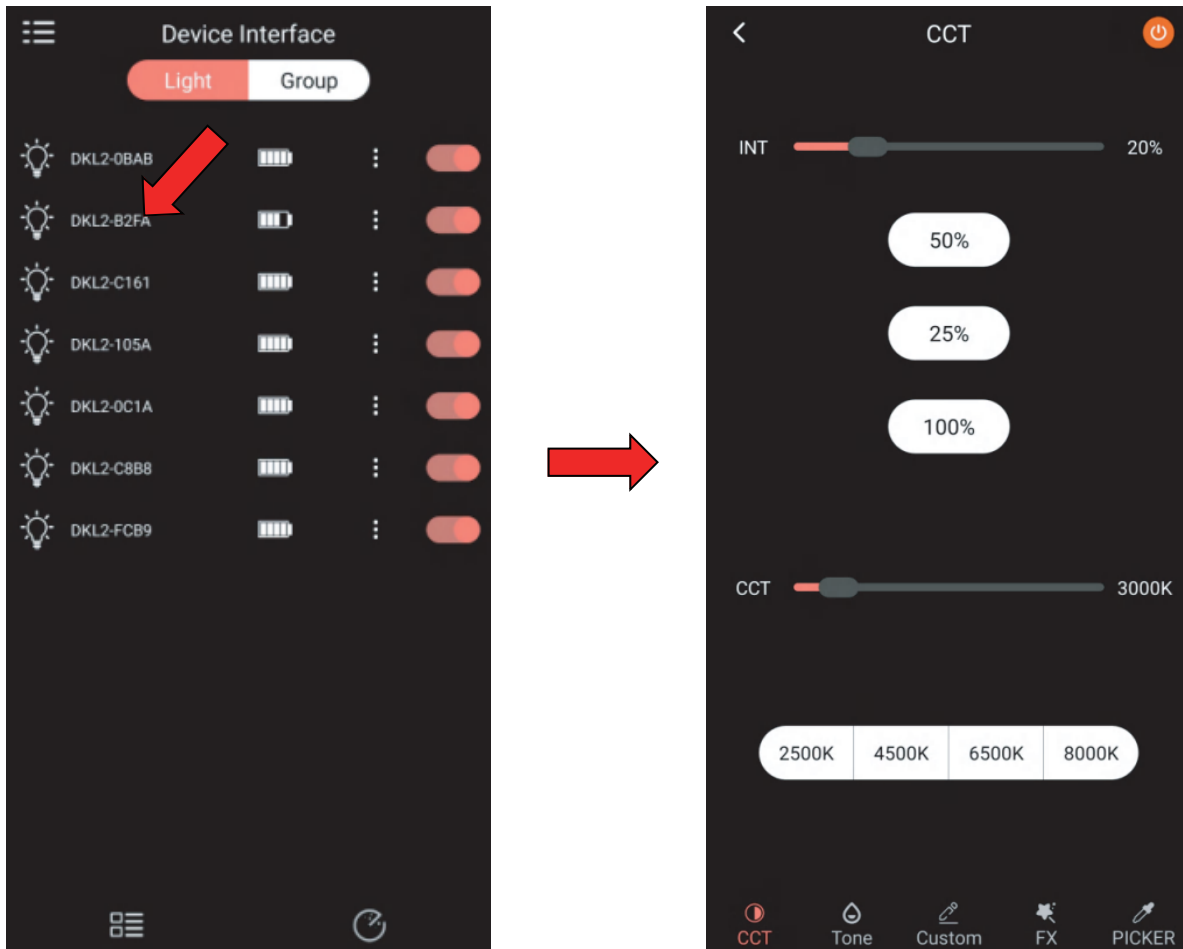

You can adjust the color temperature/hue/brightness, select an effect, pick a color, etc. in the light control interface.

Notice

1. Bi-color and RGB LED light has the following functions on the control interface: CCT, Tone, Custom, FX, Color Picker.
2. Bi-color LED light has two functions on the control interface: CCT, FX.
3. Single-color LED light has two functions on the control interface: Common, FX.

II、Main Features

2.1 CCT Mode

Tap the CCT icon at the bottom to enter the control interface. Tap the switch button to turn on/off the light. You can use the sliders to adjust the brightness from 0% to 100% and the color temperature from 2500K to 8000K as required.

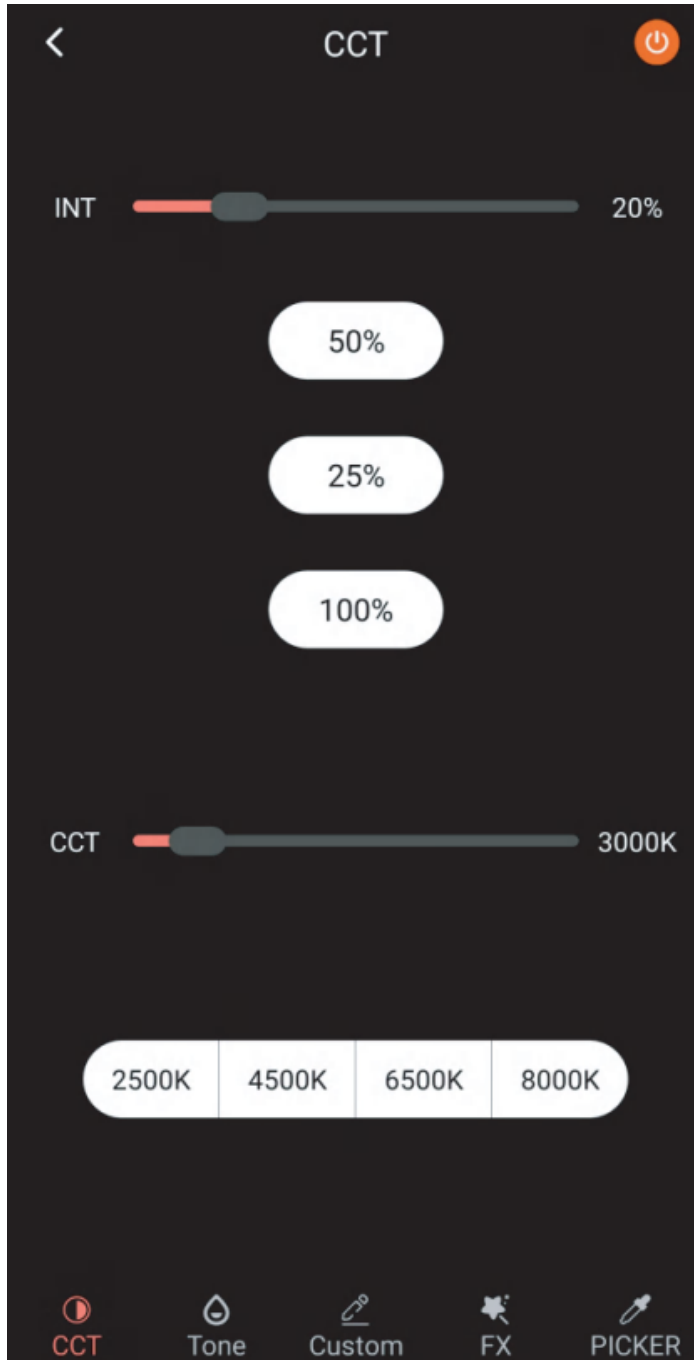

2.2 Colorful Mode

Tap the tone icon at the bottom to enter the control interface. There are two tabs across the top, HSI and RGB.

1. HSI Control: Commonly used colors are listed for your choice. Drag your finger around the color wheel to choose a color you want. Brightness, hue and saturation can all be adjusted with the sliders. Tap the switch button to turn on/off the light. Tap the save button to save your settings.
2. RGB Control: Commonly used colors are listed for your choice. Drag your finger around the color wheel to choose a color you want. Red, green and blue values can all be adjusted with the sliders. Tap the switch button to turn on/off the light. Tap the save button to save your settings.

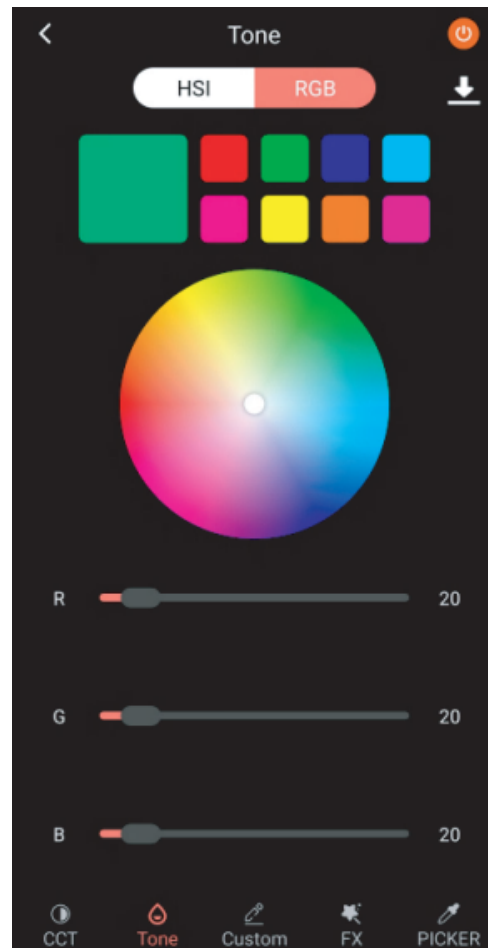
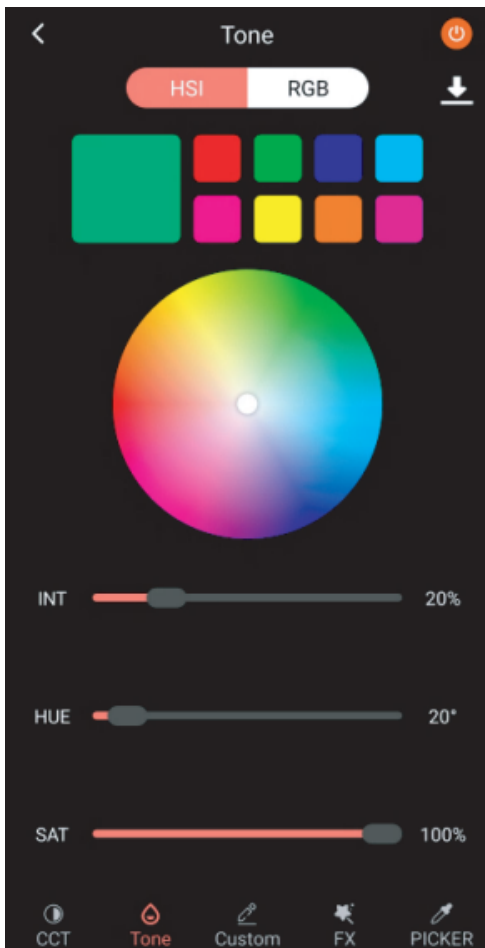

2.3 Custom Mode

Tap the custom icon at the bottom to enter the control interface. Tap the switch button to turn on/off the light. You can choose different color presets under the Custom and Colored Paper tabs and adjust the hue, saturation and brightness of each gel with the sliders.

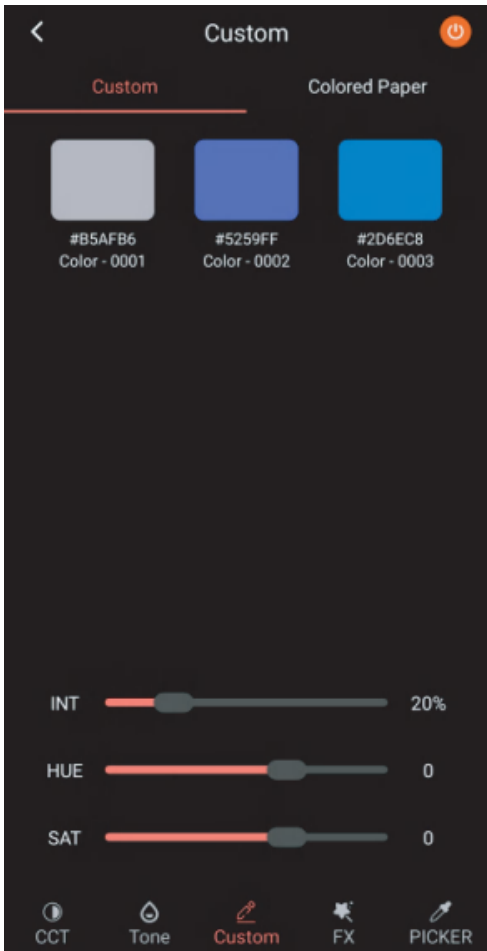

2.4 Effects Mode

Tap the FX icon at the bottom to enter the control interface. Tap the switch button to turn on/off the light. Use the sliders to adjust the brightness and speed of each effect. Effects: RGB Cycle, Flash, Disco, Lightning, Fault Light, TV, Candle, Fire, Firework, Police Car, Fire Truck, Ambulance, SOS.

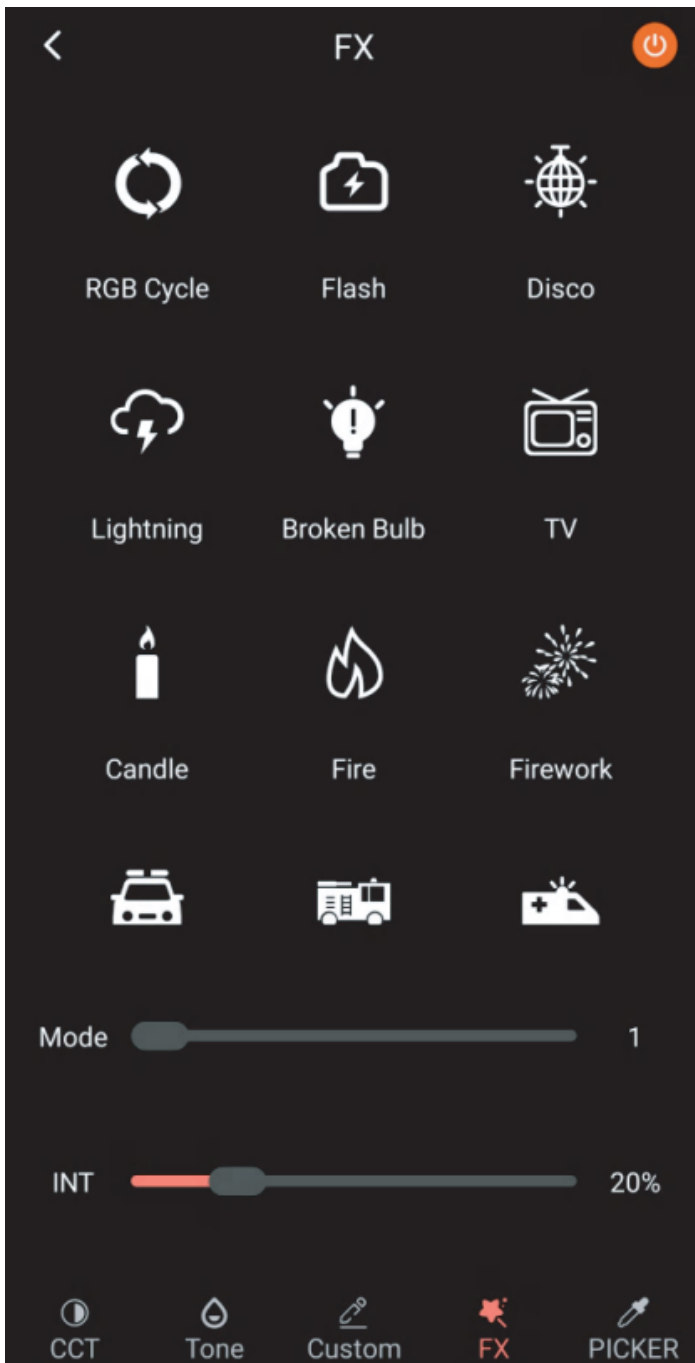

Notice: Control of FX special effects on the APP is very similar among LED lights of different models.

2.5 Color Picker

Tap the color picker icon at the bottom to enter the control interface. Tap the switch button to turn on/off the light. Tap the button in the middle to pick a color from your images and the light will replicate the color selected. Use the sliders to adjust the hue, saturation and brightness of the color. Tap the save button to save your settings.



III、Group Control

Tap the "Group" tab on the top to enter the group control interface.

1. Tap the add icon on the top right to create a new group. Then add connectable lights to the group.
2. Tap confirm.
3. Go back to the group interface.
4. Tap a group to enter its control interface.



5. Group Control Rules

RGB and Bi-color LED light has the most functions, followed by the Bi-color LED light, and finally the single-color LED light.

When the above three kinds of lights are combined, then shows the control interface with the least functions.

IV. Firmware Upgrade

Tap the menu button of a light.

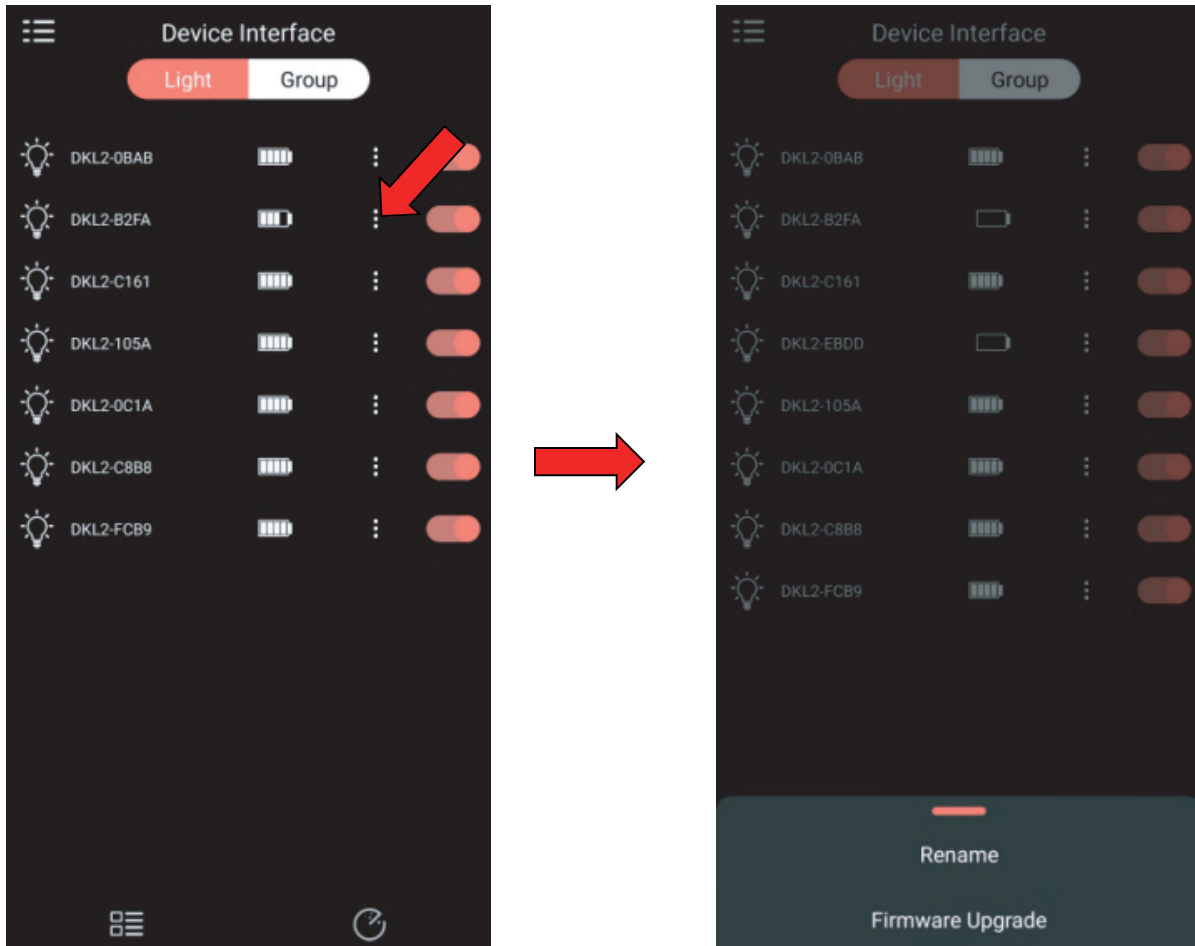

Click the firmware upgrade tab. Both Bluetooth firmware upgrade and main firmware upgrade are available. Click "check for updates" to see if there is a new version.



Notice:

1. There should be at least three bars left in the battery indicator.
2. Only one device is allowed to be upgraded at a time.
3. It is suggested to fully stretch the tube light when upgrading.

4.1 Bluetooth Firmware Upgrade

1. Click "firmware update" to the right of the Bluetooth firmware tab.
2. The upgrade prompt will pop up. Click "download now". (The light will flash red)
3. Once the upgrade is complete, the light will prompt "The upgrade is complete, please restart the device".
4. Restart the light and connect it to the APP again.

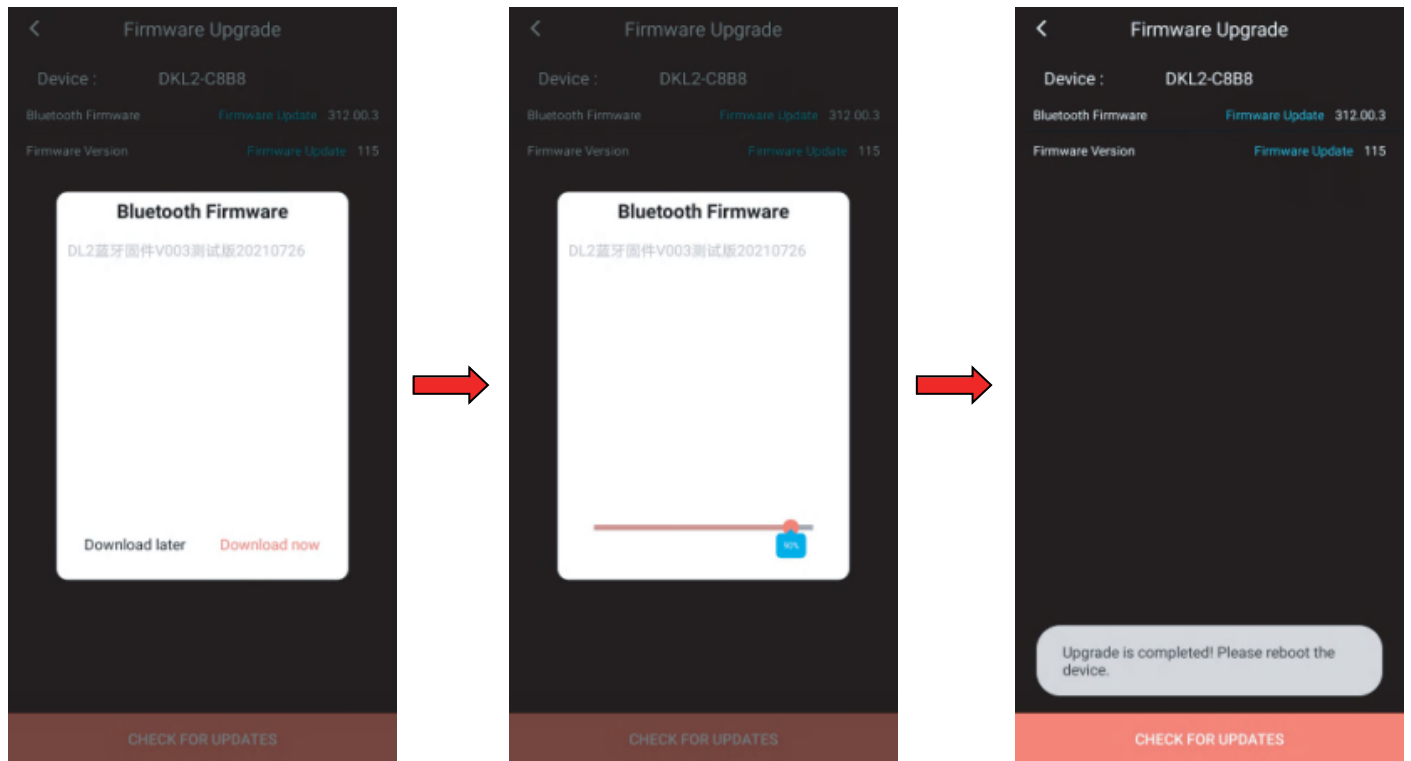

4.2 Main Firmware Upgrade

1. Click "firmware update" to the right of the main firmware tab.
2. The upgrade prompt will pop up. Click "download now". (The light will flash red)
3. Once the upgrade is complete, the light will prompt "The upgrade is complete, please restart the device".
4. Restart the light and connect it to the APP again.

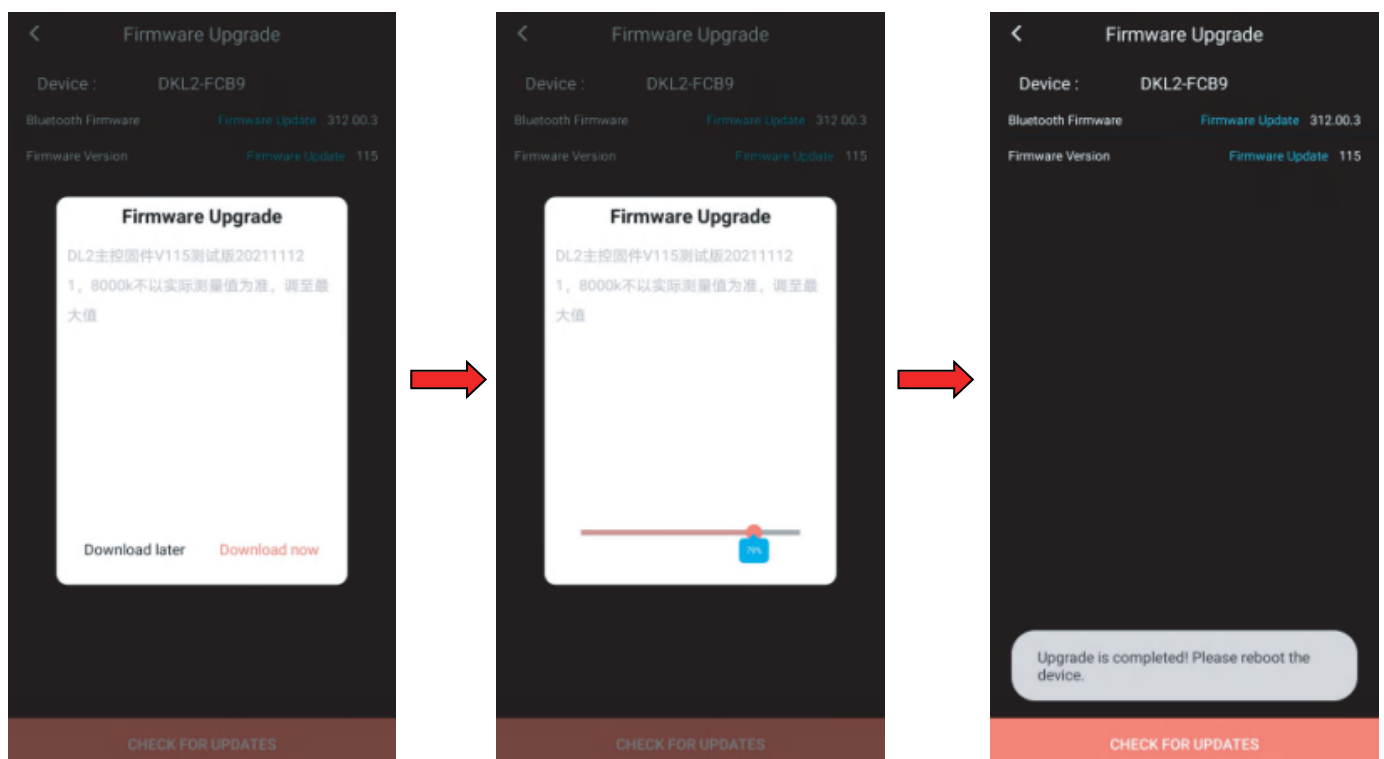



SIRUI Light APP 说明



目 录

一、软件说明

1.1 综述	01
1.2 APP下载和安装	01
1.3 启动界面	02
1.4 灯光设备界面	02
1.5 灯光控制主界面	05

二、软件操作

2.1 色温调节功能	06
2.2 色调调节功能	07
2.3 自定义功能	08
2.4 特效功能	09
2.5 拾色器功能	10

三、群组控制

四、设备固件升级

4.1 蓝牙固件升级	12
4.2 控固件升级	13

一、软件说明

1.1 综述

SIRUI Light APP适用SIRUI补光灯系列产品,用于控制色温、亮度、色相、饱和度、特效、色值、拾色、控制组网灯阵和分组管理,可以自由调节丰富色彩,轻松满足各类拍摄需求。智能控光,打造各类创意拍摄场景,实现更多可能。

1.2 APP下载和安装

请扫描二维码或在软件商店搜索“SIRUI Light”下载安装 (iOS 9.0 以上 Android 5.0以上)。



扫码下载App



说明:

APP安装完成后,使用前需要打开蓝牙, GPS位置 (蓝牙指定需要打开), 需要用户授权APP 存储权限、相机权限。



1.3 注意事项

以下界面功能以L2补光灯控制功能作为例子, L2是集成了双色温和RGB控制功能的补光灯, 本公司还有双色温补光灯、单色温补光灯, 对应产品的APP功能使用方法相似, 具体参考实际产品功能。

1.3 启动界面

在桌面上点击SIRUI Light APP的图标就会出现以下的启动界面,启动界面主要展示产品内容,启动界面预览时间大概是2秒,2秒后会自动进入设备界面。

如下图所示:

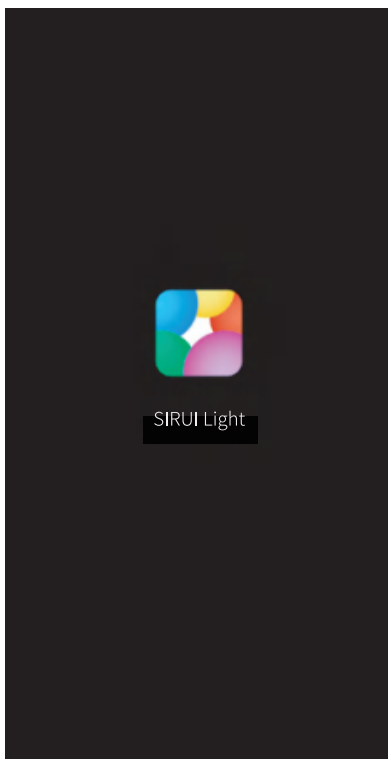

1.4 灯光设备界面

进入灯光设备界面,会自动扫描现场已经打开的灯光设备,点击设备后会自动蓝牙连接和组网,如下图所示:

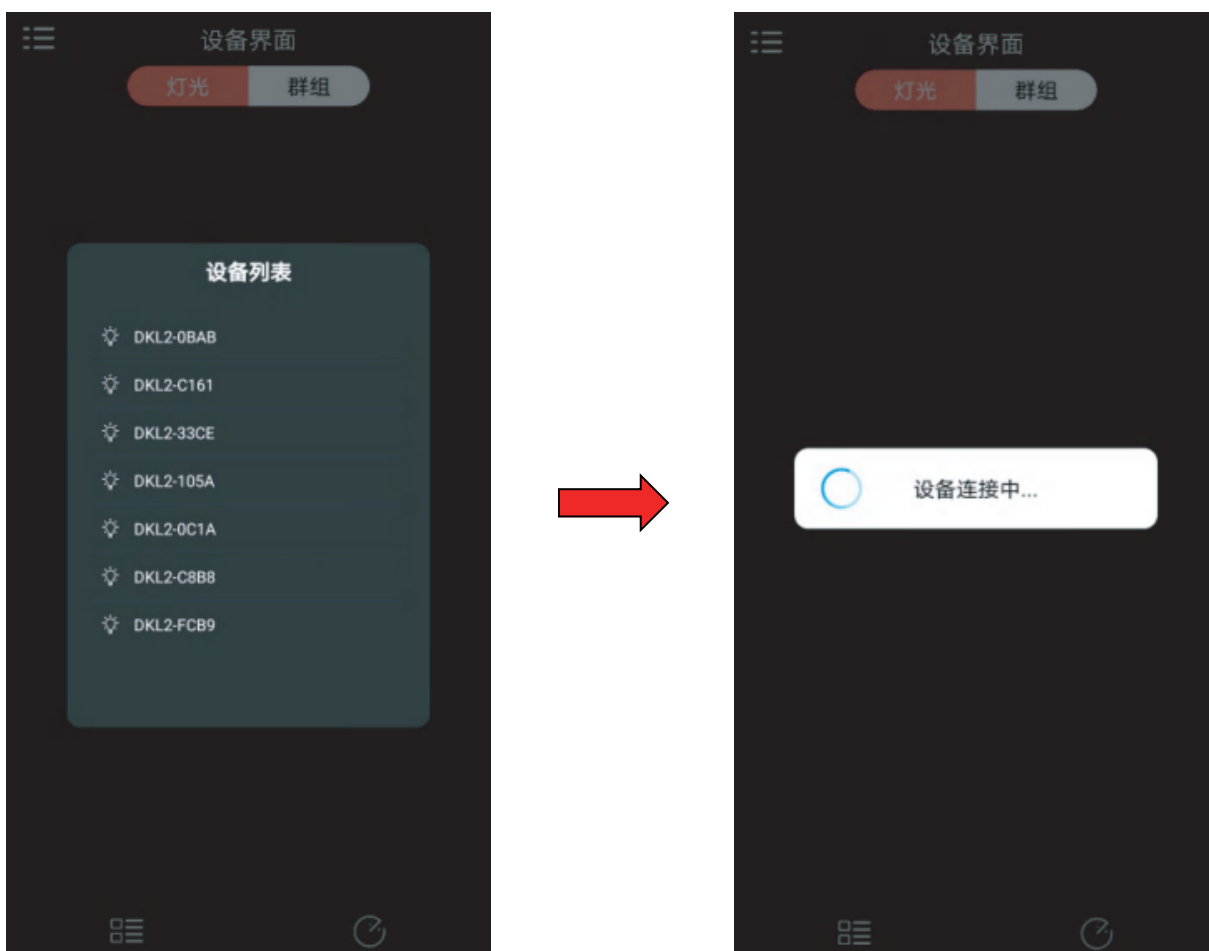

蓝牙组网完成后, 进入设备界面, 设备界面显示灯光产品对应的设备列表, 可以查看灯光电池电量, 开关灯控制, 重命名灯光, 灯光固件升级, 如下图所示:



在灯光设备界面, 点击左上角按钮, SIRUI Light APP会进入信息界面, 可以选择中英文语言, 显示《隐私条款》和《用户协议》, 点击后可以查看《隐私条款》和《用户协议》。显示当前APP版本号, 以及点击可以检查APP新版本升级。

如下图所示:



在灯光设备界面, 点击右下角的“发现”按钮, 可以查看产品的说明书, 方便用户查阅说明书和使用教程。
如下图所示:



使用手册

T120



1.5 灯光控制主界面

在灯光设备界面中, 点击一个设备名称, 此时会进入设备控制界面, 如下图所示:

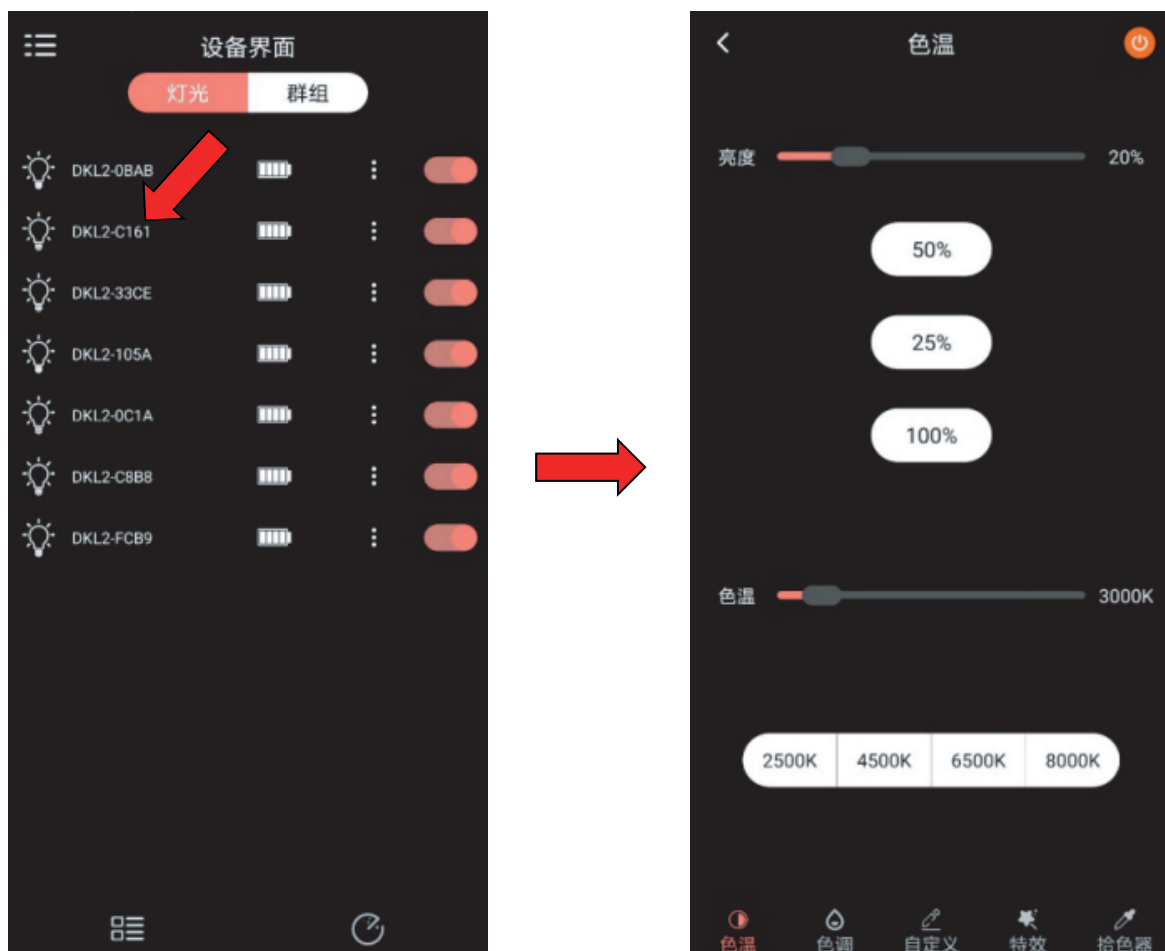

进入设备控制界面后, 该软件功能强大, 界面包含多个核心功能, 包含色温调节、色调调节、自定义、特效、拾色器等功能。

注意:

- 1、具有双色温和RGB功能的补光灯的控制界面有: 色温调节、色调调节、自定义、特效、拾色器。
- 2、具有双色温功能的补光灯的控制界面有: 色温调节、特效。
- 3、具有单色温功能的补光灯的控制界面有: 常规、特效。

二、软件操作

2.1 色温调节功能

用户点击底部菜单栏的色温按钮,进入色温控制页面,可点击开关按钮,可以设置冷光值、暖光值(可调范围为2500K-8000K),可以快捷选择2500K、4500K、6500K、8000K灯光值,可以设置灯光亮度0-100%,可以快捷设置亮度为25%、50%、100%。

操作如图:

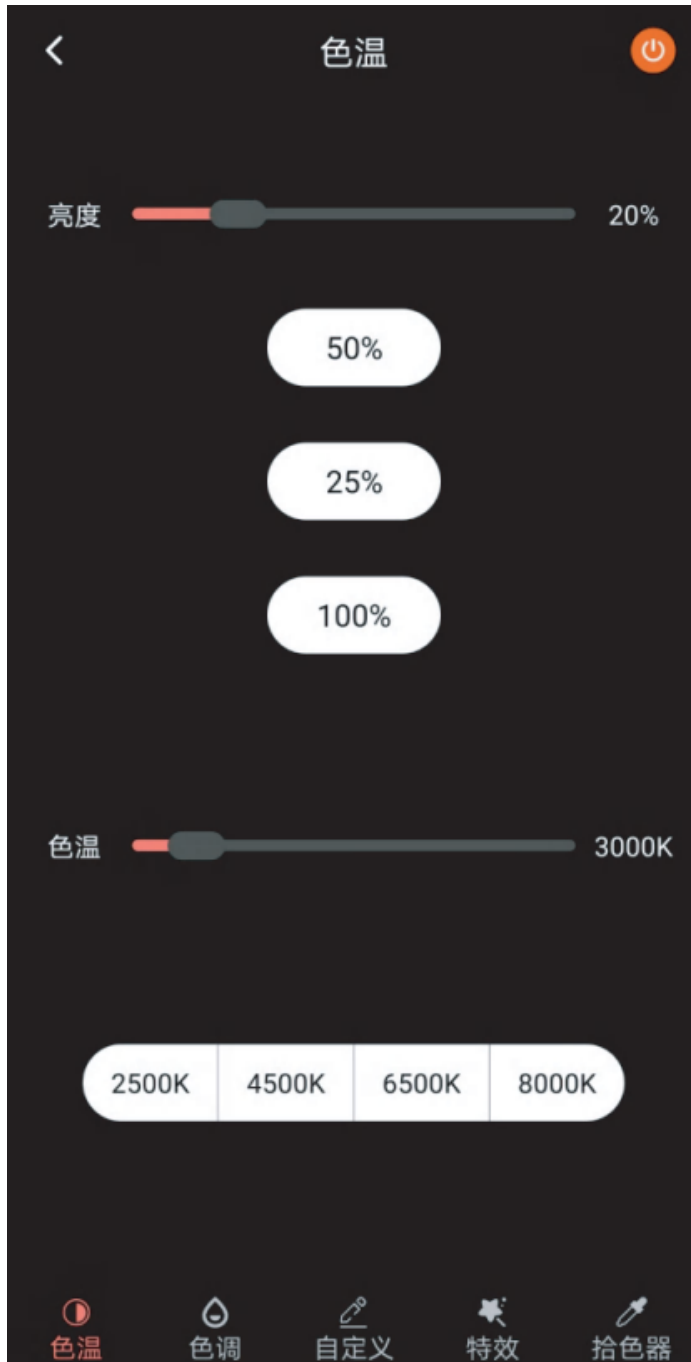

2.2 色调调节功能

用户点击底部菜单栏的色调按钮,进入色调控制页面,可以选择H S I控制或者RGB控制:

- 1、H S I控制:可以快捷选择常用颜色设置灯光颜色,可以通过色环快速设置颜色值,可以设置亮度、色相、饱和度,可以开关灯控制,右上角可以保存设定的色值。
- 2、RGB控制:可以快捷选择常用颜色设置灯光颜色,可以通过色环快速设置颜色值,可以设置亮度、红色值、绿色值、蓝色值,可以开关灯控制,右上角可以保存设定的色值。

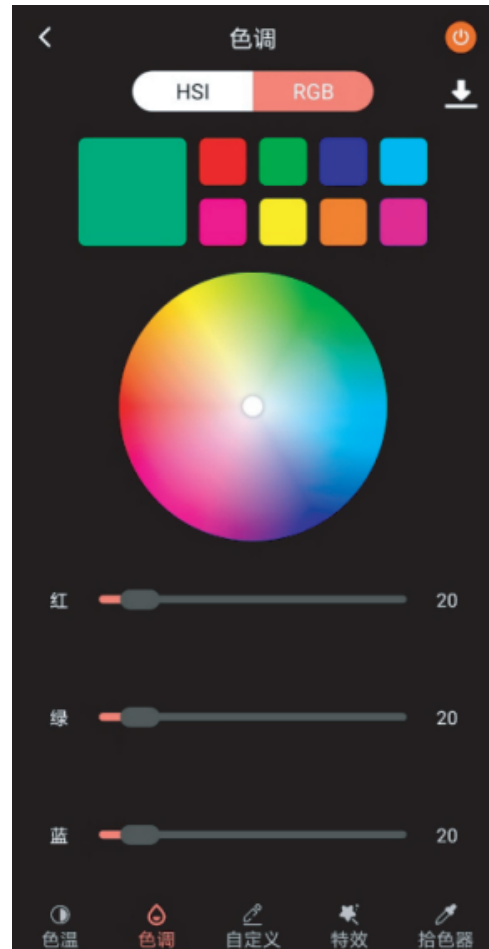
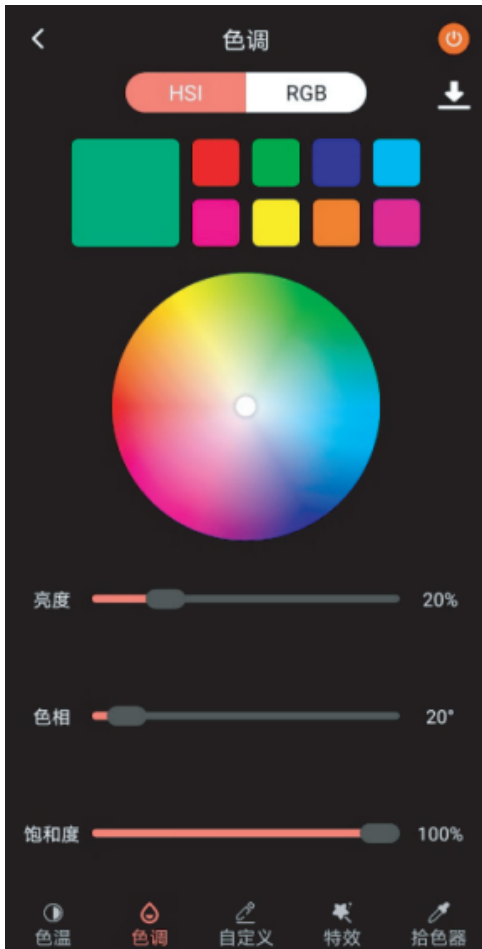

2.3 自定义功能

用户点击底部菜单栏的自定义按钮,进入自定义控制页面,可点击开关按钮控制灯光开关,可以设置色相补偿,可以设置饱和度补偿,可以设置灯光亮度0-100%,可以选择自定义色值(色温和色调保存的色值)。

操作如图:

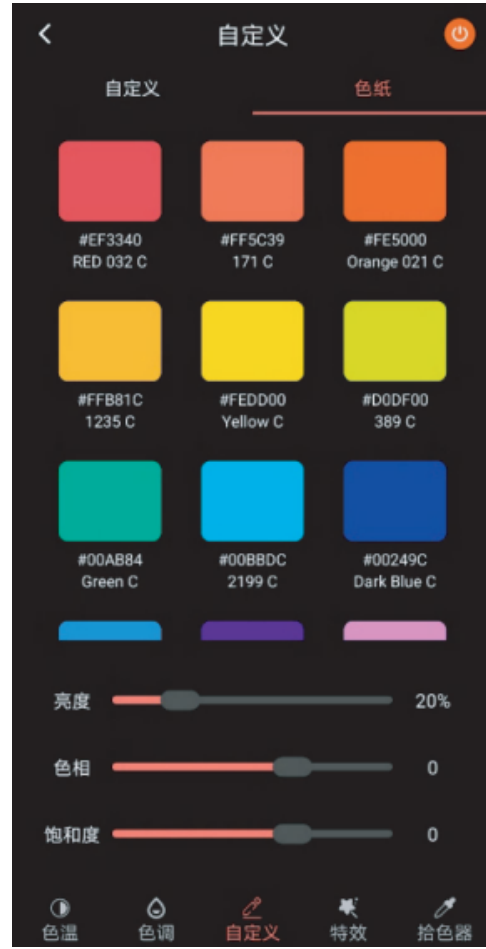
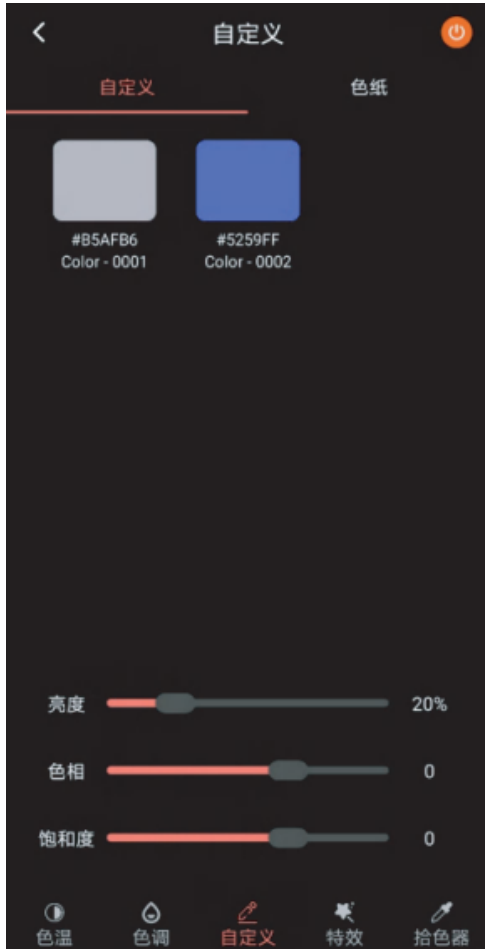

2.4 特效功能

用户点击底部菜单栏的特效按钮,进入特效控制页面,可点击开关按钮控制灯光开关,可以设置特效速度,可以设置灯光亮度0-100%,特效效果有:RGB循环、闪光灯、迪斯科、闪电、故障灯、电视荧幕、蜡烛、火焰、烟花、警车、消防车、救护车、音乐、SOS。

操作如图:



注意事项:不同型号灯光产品,对应产品的APP特效功能使用方法相似,具体参考实际产品功能。

2.5 拾色器功能

用户点击底部菜单栏的拾色器按钮,进入拾色器控制页面,可点击开关按钮控制灯光开关,按取色按钮可以打开手机摄像头获取指定的颜色值,饱和度、色值和颜色显示在画面中,可以设置色相补偿,可以设置饱和度补偿,可以设置灯光亮度0-100%;拾取的颜色值可以保存到自定义列表,操作如图:

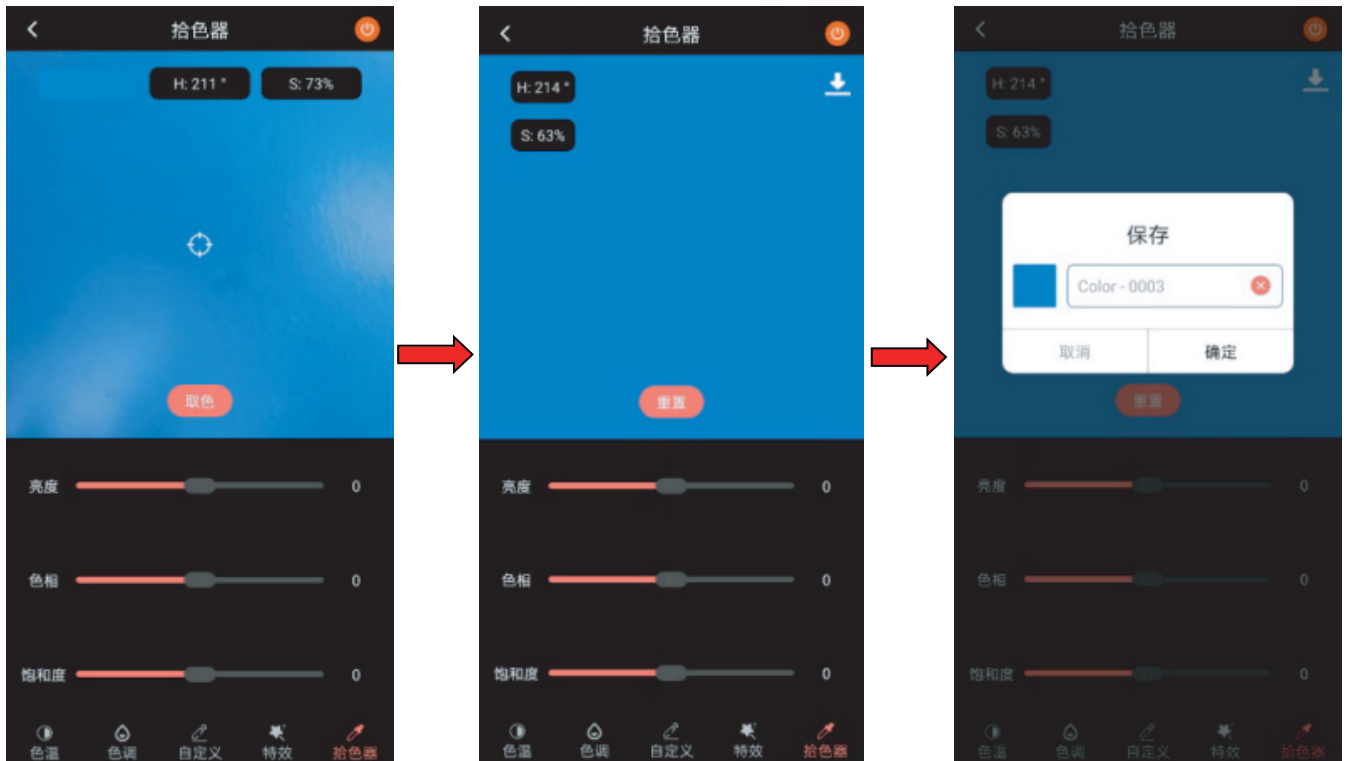

三、群组控制

在灯光设备界面中,点击“灯光”按钮右边的“群组”按钮,此时会进入群组控制界面,如下图所示:

- 1、点击右上角的“+”,可以添加群组,可以选择灯光设备进行分组控制。
- 2、添加完后点确认。
- 3、返回到群组界面。
- 4、点击群组名称可以进入到灯光控制界面,界面包含多个核心功能,包含色温调节、色调调节、自定义、特效、拾色器功能。



5、群组分组控制规则

A、功能最多的就是:双色温+RGB

B、其次是:双色温

C、最后是:单色温

A > B > C多灯组合时取交集

比如,同时存在A、B、C,点击群组 或者 全部设备时,使用进入最少功能 C控制界面。

四、设备固件升级

在灯光设备界面，点击一台灯光的菜单按钮，弹出固件升级菜单，如图所示：



点击固件升级，进入固件升级页面，固件升级有蓝牙固件升级和主控固件升级，点击检查更新可以查看是否有固件更新：



升级注意事项：

- 1、保持设备电量三格以上。
- 2、每次升级只支持一台设备，多台设备需要逐台升级。
- 3、建议拉开第二节灯管升级，这样蓝牙信号更好。

4.1 蓝牙固件升级

- 1、点击蓝牙固件右边的“固件更新”。
- 2、弹出升级提示,再点立即下载,设备就会进入升级状态(此时补光灯会红色闪烁,表示正在升级状态)。
- 3、升级进度条会充0%至100%增加,升级完成后提示“升级成功,请重启设备”。
- 4、重启设备重新连接APP使用即可。



4.2 主控固件升级

- 1、点击主控固件右边的“固件更新”。
- 2、弹出升级提示,再点立即下载,设备就会进入升级状态(此时补光灯会红色闪烁,表示正在升级状态)。
- 3、升级进度条会充0%至100%增加,升级完成后提示“升级成功,请重启设备”。
- 4、重启设备重新连接APP使用即可。

