

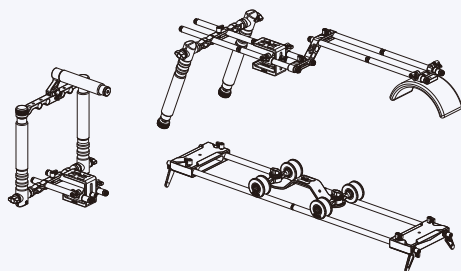

Professional Photographic Equipment

INSTRUCTIONS

VSK Series Video Survival Kit



Guangdong SIRUI optical co.,ltd

Address: The Third Industrial District, Wuguishan Town, Zhongshan City, Guangdong, China
Tel: 0086-760-88997373 Fax: 0086-760-88207062 Service Hotline: 0086-400-8302299
E-mail: info@sirui-photo.com http://www.sirui.com P.C: 528458

VSK Series Data Chart

max	Maximum Load	Weight	Height	Depth	Width
	kg/lb	kg/lb	mm/inch	mm/inch	mm/inch
	4/8.8	1.2/2.6	295/11.6	203/8.0	326/12.8
	4/8.8	1.3/2.9	366/14.4	209/8.2	326/12.8
	12/26.5	0.6/1.3	58/2.3	165/6.5	262/10.3
	8/17.6	2/4.4	111/4.4	198/7.8	863/34.0
	4/8.8	1.8/4.0	315/12.4	326/12.8	849/33.5
Cage					
Lowboy					
Table Dolly					
Slider					
Shoulder Rig					

Basic structure

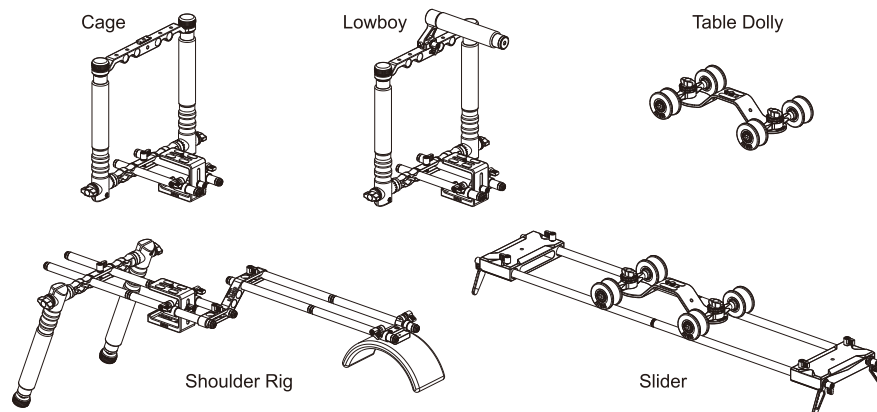

Fig. 1

Constructing the Cage

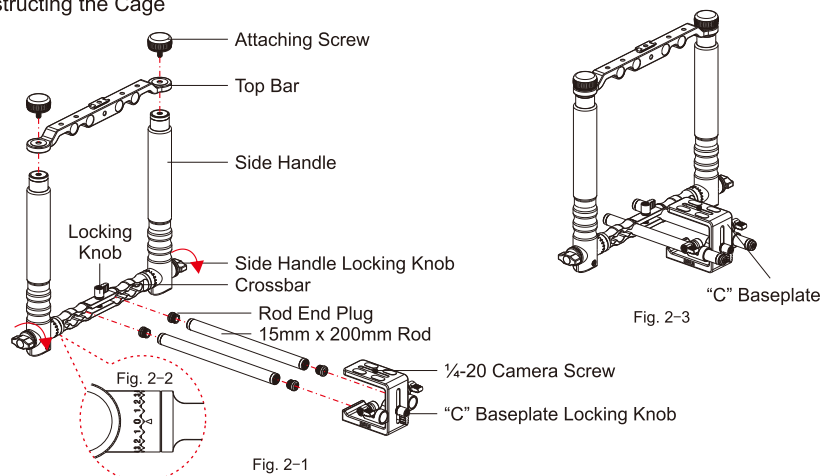

Fig. 2-1

Fig. 2-3

Assembly and disassembly of the Lowboy

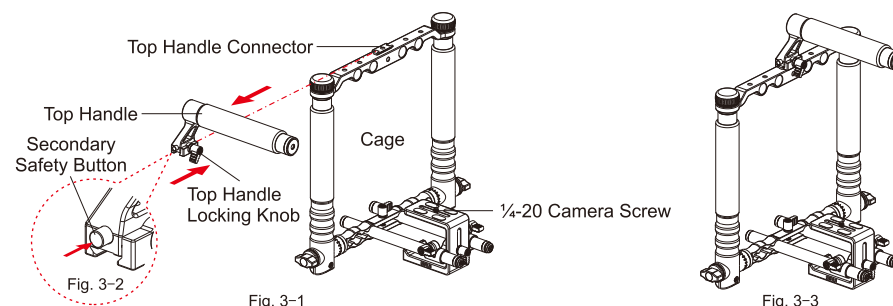

Fig. 3-1

Fig. 3-3

1. Basic structure

- VSK-2 can be assembled to be 2 products – Table Dolly & Slider as fig. 1.
- VSK-3 can be assembled to be 3 products – Cage, Cowboy, Shoulder Rig.

2. Constructing the Cage (Fig. 1)

- The cage comes partially assembled when you first purchase the VSK-3. To complete construction, you need to place the Top Bar onto the Side Handles and connect with the Attaching Screws. The indicator arrow at the base of the Side Handles should be aligned with the arrow on the Crossbar (Fig. 2-2). If they are not aligned, loosen the Side Handle Locking Knob, align the arrows and lock the Side Handle Locking Knob.
- As shown in Fig. 2-1, insert the 15mm × 200mm Rod into the Crossbar and tighten the Locking Knob.
- As shown in Fig. 2-1, attach the "C" Baseplate onto the 15mm × 200mm Rod and tighten the "C" Baseplate Locking Knob.
- Attach the camera onto the "C" Baseplate.

3. Assembling the Lowboy

As shown in Fig. 3-1, slide the Top Handle Connector onto the Top Bar from the side - the alignment pin should click into position. Lock the Top Handle by turning the Top Handle Locking Knob.

4. Disassembling the Lowboy

As shown in Fig. 3-1, loosen the Top Handle Locking Knob, press the Secondary Safety Button (Fig. 3-2), and slide out from the side.

Attention:

Do not exceed the recommended load limit of the VSK-5 components. (Please refer to product specifications).

Please make sure that the locks are securely tightened when in use.

This product should not be used in environments that exceed the following conditions (-40 ~ +100°C/-40 ~ +212°F). And, when used in damp, dirty or dusty environments, please clean and dry thoroughly after use, to assure proper functioning in the future. It is not recommended to expose this product to saltwater. If exposed, please clean with mild soap and warm water and towel dry.

Please keep from high temperatures and direct exposure to bright sunlight for extended periods of time. For example, do not leave the product inside a car, under a windshield or on a windowsill.

Please do not leave the equipment alone in a public place, which can be an inconvenience or hazard to others.

To protect your camera gear, please remove it from the VSK-5 when transporting from place to place.

Please use a soft towel with warm water and mild soap to clean the locking system and gliding parts when necessary. Towel dry before storing the product.

Under most situations, there is no need to lubricate any parts of this product. The addition of most lubricants will gum up the mechanisms and reduce their normal gliding characteristics. Please call or email us if you have any questions or special needs.

Please keep this product away from all electrical power sources.

Specifications are subject to change without notice.

Constructing the Shoulder Rig

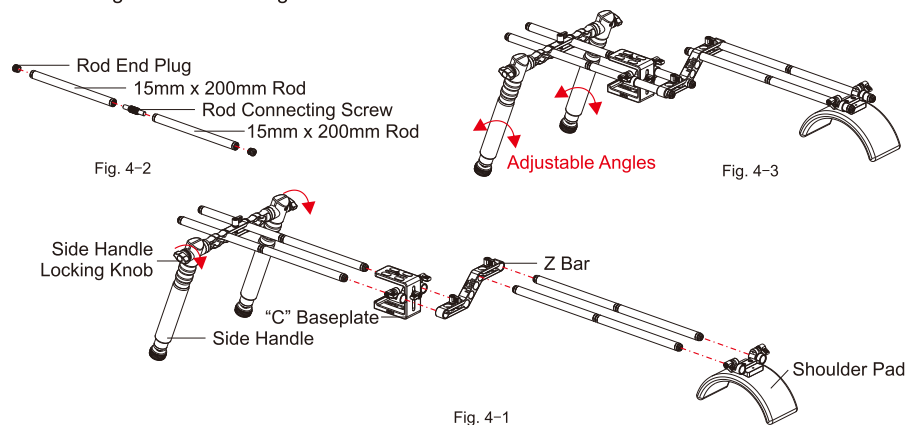

Constructing the Slider

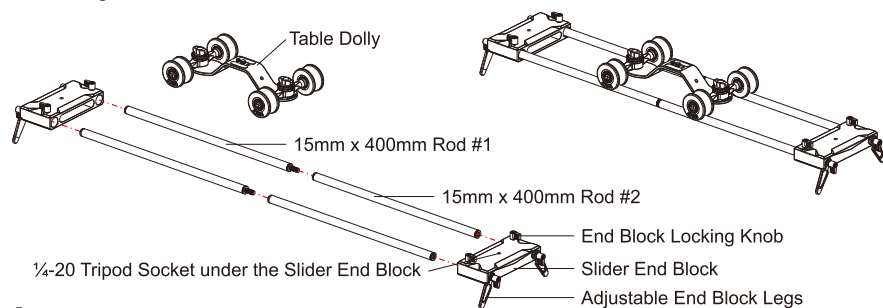
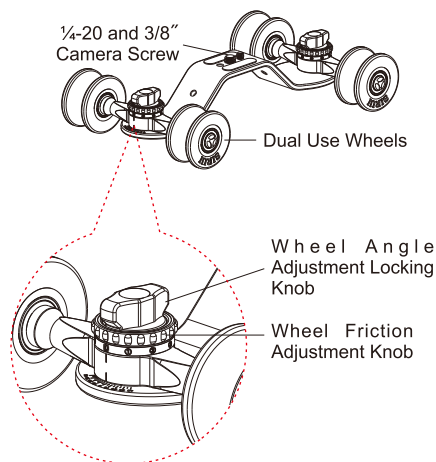

Table Dolly Operation



5. Constructing the Shoulder Rig

- ① To convert the Cage into a Shoulder Rig, detach the Top Bar from the Side Handles by unscrewing the Attaching Screws. Loosen the Side Handle Locking Knob, individually move the Side Handles down 180° and lock the Side Handle Locking Knob in position. You can adjust the angle of the Side Handles after assembling the rest of the Shoulder Rig.

As shown in Fig. 4-2, according to your needs, you can lengthen the 15mm × 200mm Rod by attaching a second rod with the Rod Connecting Screw.

- ② As shown in Fig. 4-1, put the 15mm × 200mm Rods into the Crossbar and lock.
- ③ As shown in Fig. 4-1, attach the "C" Baseplate onto the 15mm × 200mm Rod, position it over the Crossbar and lock in position. You can adjust the final position when you attach a camera and accessories onto the "C" Baseplate. (Attention: the end of the Rod should pass through the "C" Baseplate to facilitate attaching the Z Bar.)
- ④ As shown in Fig. 4-1, attach the Z Bar onto the 15mm × 200mm Rod and lock. You can position the Z Bar in the higher or lower position, depending upon your requirements.
- ⑤ As shown in Fig. 4-1, attach the other two 15mm × 200mm Rods onto the other side of the Z Bar and lock.
- ⑥ As shown in Fig. 4-1, attach the Shoulder Pad onto the 15mm × 200mm Rods and lock in position. You can adjust the position of the Shoulder Pad, as needed.
- ⑦ As shown in Fig. 4-3, according to your needs, you can adjust the angle of the Side Handle, and the position of the Crossbar, Shoulder Pad and "C" Baseplate to obtain the most comfortable shooting configuration.

VSK-3 Packing Box

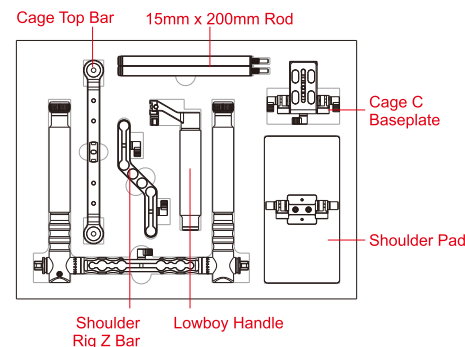

VSK-2 Packing Box

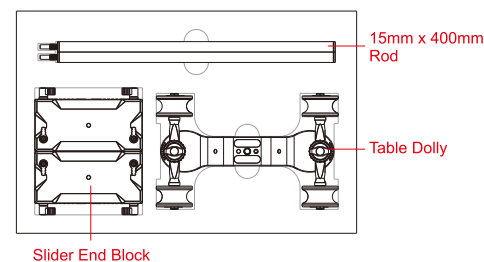

6. Constructing the Slider

- ① As shown in Fig. 5, connect 15x400 Rod #1 and 15x400 Rod #2 with the Rod Connecting Screw, then put into the Slider End Blocks and tighten the End Block Locking Knobs. You can use the Adjustable End Block Legs to make sure the Slider is level when working on uneven terrain.
- ② Attach the camera onto the Table Dolly Roller and put it on the Slider.
- ③ There is a 1/4-20 socket on the bottom of the End Block that allows you to attach a tripod under the Slider.
- ④ You can use any 15mm tube with the End Blocks, when you require a longer rail length.

Note: To insure maximum stability and safety, make sure the rods are completely pushed into the End Block and locked in place. Do not use excessive force when tightening the locks.

7. Table Dolly Operation(Fig. 6)

The Table Dolly Roller has uniquely designed Dual Use Wheels that allow you to use them on the Sirui VSK-2 Slider or on flat surfaces for low angle shooting.

- ① Make sure the wheels are at the "0" position before placing it on the Slider Rods.
- ② When you use the Table Dolly on a flat surface, you can adjust the wheel angles to move in an arc or circle for various creative effects. The calibrated scales make adjustment fast and accurate.
- ③ Based on the weight of the camera system and desired rolling speed, you can control the wheel friction by turning the Wheel Friction Adjustment Knob.
- ④ You can attach your camera directly onto the 1/4-20 screw (remove the 3/8" screw first) or you can attach a ball head onto the 3/8" screw (remove the 1/4-20 screw first) for greater movement and flexibility.

8. VSK-3 Packing Box

Please refer to Fig. 7 for storage of the parts for VSK-3.

9. VSK-2 Packing Box

Please refer to the Fig. 8 for storage of the parts for VSK-2.