

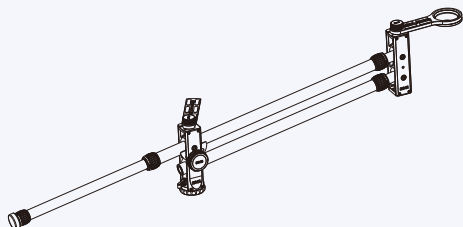

Professional Photographic Equipment

INSTRUCTIONS

VTJ-1.8 Video Travel Jib



Guangdong SIRUI optical co.,ltd

Address: The Third Industrial District, Wuguishan Town, Zhongshan City, Guangdong, China
Tel: 0086-760-88997373 Fax: 0086-760-88207062 Service Hotline: 0086-400-8302299
E-mail: info@sirui-photo.com http://www.sirui.com P.C: 528458

VTJ-1.8 Data Chart

Max	Load	4.5/9.9
	kg/lb	
	Weight	2.7/6.0
	kg/lb	
Height	mm/inch	225/8.9
Disassembled Length	mm/inch	850/33.5
Min.Length	mm/inch	1270/50.0
Max.Length	mm/inch	1820/71.7

VTJ-1.8

①

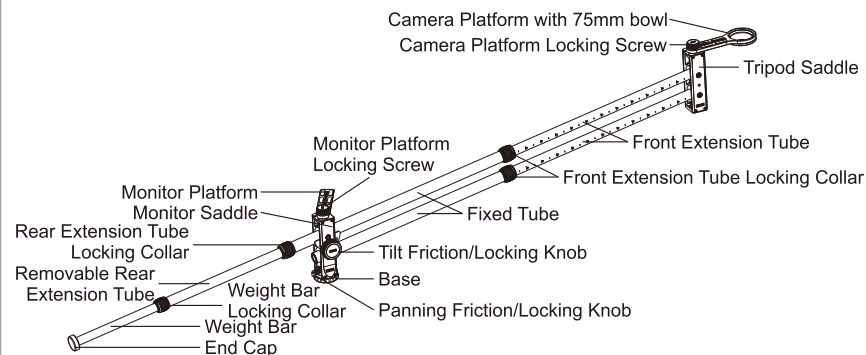

②

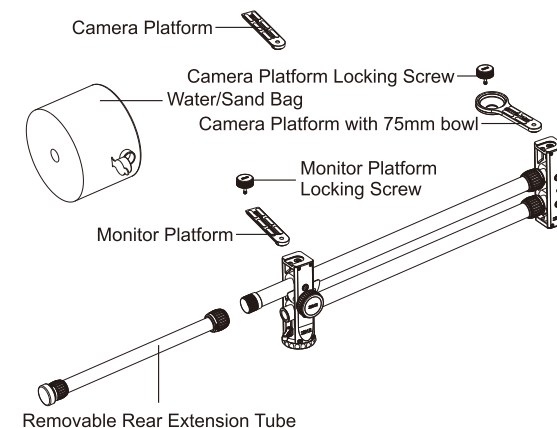

③

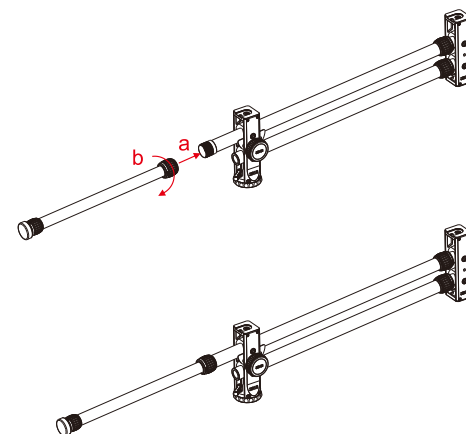

④

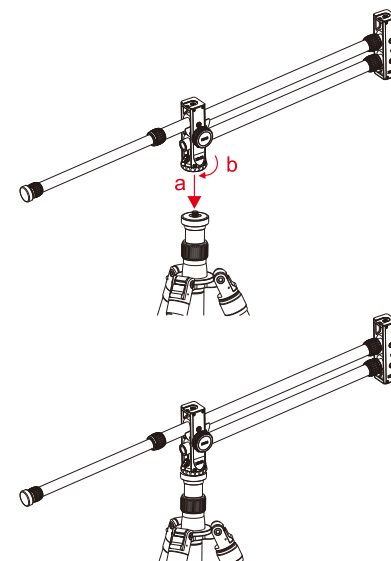

⑤

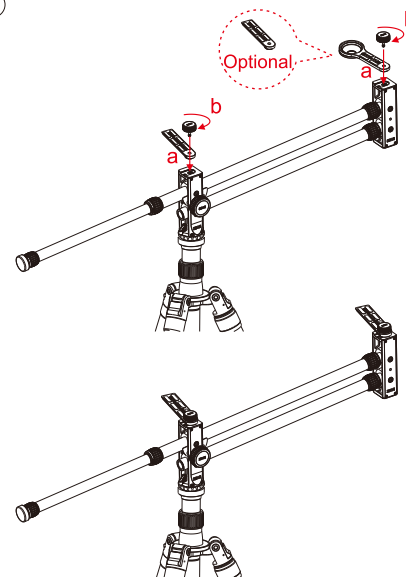

1. Basic Structure

2. Removable parts of the Jib

3. Attaching the Removable Rear Extension Tube

Put the Removable Rear Extension Tube into the Fixed Tube and tighten the Rear Extension Tube Locking Collar by turning in a clockwise direction.

4. Attaching a tripod

① If the screw size of your tripod is 1/4-20, then you will need to purchase an adapter that converts to

3/8". Check your tripod manual to see if your tripod has a reversible screw that has both 1/4-20 and 3/8" sizes.

② Align the 3/8" socket at the bottom of the jib with the 3/8" screw of the tripod, and turn the base of the jib in a clockwise direction until it is locked.

5. Attaching the Camera or Monitor Platform

Attaching the Platform (Camera, Monitor or Camera Platform with bowl)

Attach the provided Platform onto the Camera (front) and Monitor (back) Saddles by sliding in from the rear of the saddle. Insert the Platform Locking Screw and tighten it by turning in a clockwise direction.

Note: The straight Camera and Monitor Platforms are identical in appearance and are completely interchangeable.

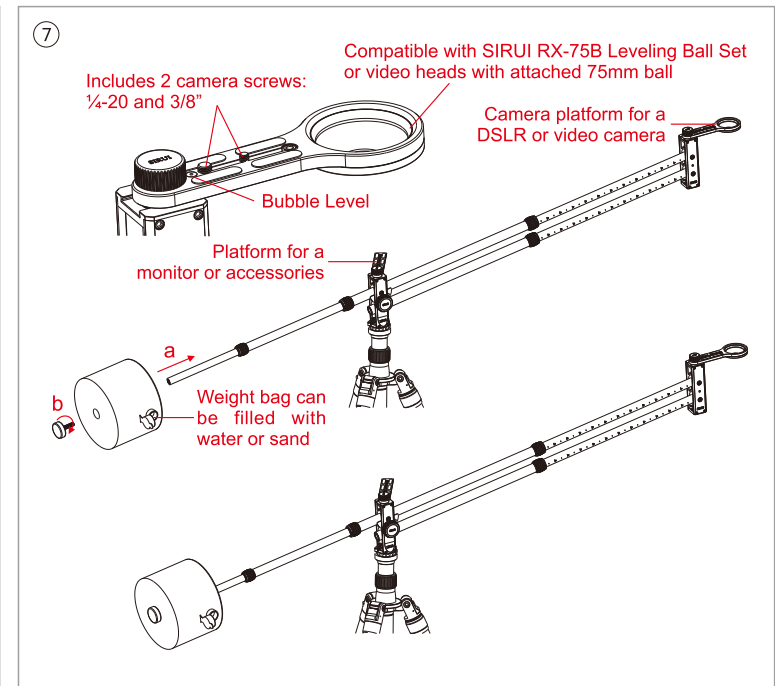
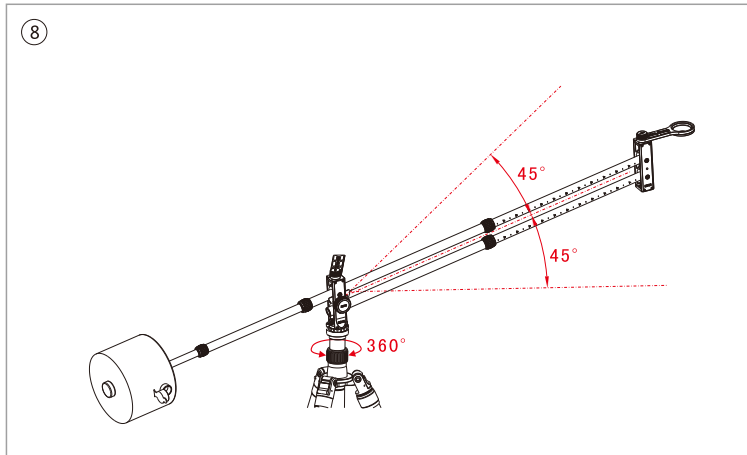
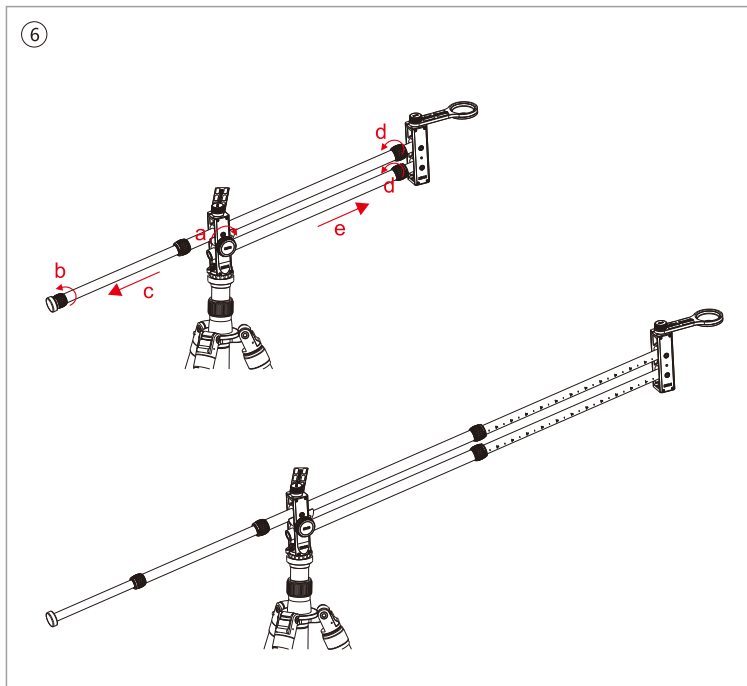

6. Extending the Jib

Lock the Tilt Friction/Locking Knob (a), loosen the Front Extension Tube Locking Collar (d) and Weight Bar Locking Collar (b) and tighten the locking collars after you extend the Jib tubes.
When adjusting the length of the Extension tubes, use the scale for quick alignment.

7. Attaching the equipment

- ① Lock the Tilt Friction/Locking Knob, and attach the camera or video camera onto the provided Camera Platform. Put the monitor and accessories onto the Monitor Platform.
Note: Make sure your camera is securely attached to the Camera Platform. Do not release your camera until you are holding onto the Jib.
- ② Remove the End Cap (b) from the Weight Bar and slide (a) the Water/Sand Bag - filled with water or sand - onto the Weight Bar. Replace the End Cap onto the Weight Bar. Adjust the length of the Weight Bar and/or adjust the amount of water or sand that is in the Water/Sand Bag, to ensure the front and back weight is evenly balanced. You can also purchase other counterbalance weights to replace the Water/Sand Bag. A properly balanced Jib will allow you to place the Jib in any position and the Jib will not move. You may prefer to have more weight to the front or back of the Jib, depending on your requirements.
Note: When you need to adjust the length of the Weight Bar, you will need to release the downward force on the Rear Extension Tube, to make adjustments easier. Lock the Tilt Friction/Locking Knob and slightly lift the Water/Sand Bag or counterbalance weight and adjustments will be very fast and easy.
- ③ For critical leveling of the Camera Platform, refer to the bubble level.

8. Usage of the Video Travel Jib

- ① The maximum extended length of the Jib is 182cm.
- ② The maximum load capacity of the Camera Platform is 4.5kg, please do not exceed this limit.
- ③ Loosening the Panning Friction/Locking Knob allows the Jib to turn 360°. It can be stopped and locked at any direction.
- ④ The Jib can move 45° up and down and can be locked at any position within this range.
- ⑤ When you have finished working with the Jib, you should make sure it is clean before disassembling it and placing it in its carry case.
- ⑥ When you need to remove the jib from the tripod, please lock the base locking knob on the bottom of the jib and turn the jib in a counter clockwise direction to unscrew the jib.

Attention:

- Do not exceed the recommended load limit of the jib, head and/or tripod. (Please refer to product specifications.)
- Please make sure that the locks are securely tightened when in use.
- This product should not be used in environments that exceed the following conditions (-40 ~ +100°C/-40 ~ +212°F). And, when used in damp, dirty or dusty environments, please clean and dry thoroughly after use, to assure proper functioning in the future. It is not recommended to expose this product to saltwater. If exposed, please clean with mild soap and warm water and towel dry.
- Please keep from high temperatures and direct exposure to bright sunlight for extended periods of time.
- Please do not leave the equipment alone in a public place, which can be an inconvenience or hazard to others.
- To protect your camera gear, please remove it from the tripod/ball head when transporting from place to place.
- Please use a soft towel with warm water and mild soap to clean the locking system and gliding parts when necessary. Towel dry before storing the product.
- Under most situations, there is no need to lubricate any parts of this product. The addition of most lubricants will gum up the mechanisms and reduce their normal gliding characteristics. Please call or email us if you have any questions or special needs.
- Please keep this product away from all electrical power sources.

Specifications are subject to change without notice.