



Patent No.:201610445963.1

Instructions

SIRUI Swift M1 Gimbal



SIRUI Website

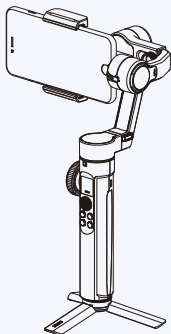

GUANGDONG SIRUI OPTICAL CO.,LTD.

Add: The Third Industrial District, Wuguishan Town, Zhongshan City,
Guangdong, China (Zip Code: 528458)

Tel: 86-760-88897373 Fax: 86-760-88207062

E-mail: info@sirui-photo.com Website: www.sirui.com

Know the SIRUI Swift M1 Gimbal

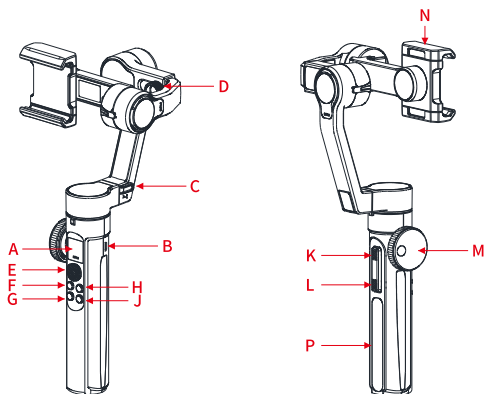

A. OLED User Interface

B. USB Port

C. Folding Release Button

D. Balance Adjustment Knob

E. Tilting/Panning Control Knob

F. Shutter Button

G. Instant App Control Button

H. Mode Switch Button

J. Power Switch

K. Function Key 1

L. Function Key 2

M. Wheel Dial

N. Phone clamp

P. Gimbal Handle

※ Mobile phone is not included.

Included:



Swift M1 Gimbal x 1

EPP Protective Case x 1

Tripod x 1

USB Cable x 1

Storage Bag x 1

Unfold the Gimbal:

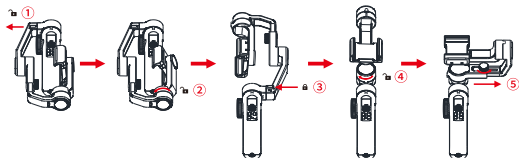

Fold the Gimbal:

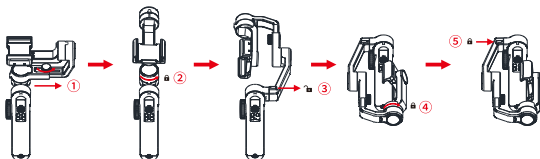

1. Download the SIRUI Swift App

The SIRUI Swift App is required for use with the Gimbal. Search for the "SIRUI Swift" App on your Mobile App Store or scan the QR code below to download.



 The SIRUI Swift app requires iOS 9.0/Android 5.0 or later.

2. Charge and Power on/off the Gimbal

Before use, plug the USB cable provided into the mini USB port on the handle and the other end to a power source (2A charging current) to charge for 2 hours. The charging status will be displayed on the OLED UI.



USB Charging Port
(5V 2A)

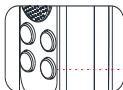

To power on/off the Gimbal,
press and hold the Power
Switch for 3 seconds.

3. Attach the mobile phone to the Gimbal

 It is recommended to power off the Gimbal before attaching or balancing a mobile phone.

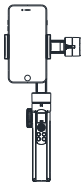
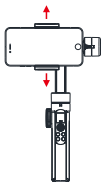

※ Rotate the phone clamp to adjust the orientation of the phone to portrait or landscape.

Turn the Balance Adjustment Knob to level the mobile phone:

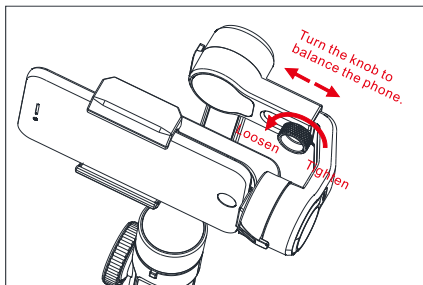

Note: The Gimbal will not function properly if the phone is not balanced.

4. Connect the SIRUI Swift App and the Swift M1 Gimbal



① Turn on the mobile Bluetooth



② Power up the Gimbal





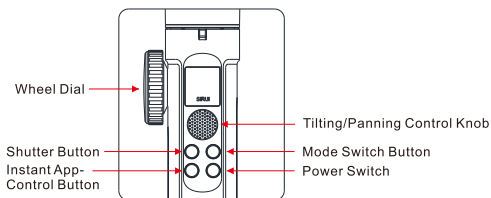

SIRUI Swift

③ Activate the SIRUI Swift App and follow the steps to connect the App and the SIRUI Swift M1 Gimbal.





5. Operation



- ⦿ To power up or off the Gimbal, press and hold the Power Switch for 3 seconds.
- ⦿ Press the shutter button to control shooting when connected to the App.
- ⦿ Press the Mode Switch Button to select one of the 4 Shooting Modes.

-  **TL** Tilting-Following Locked:
Switch to lock the Tilting-Following feature while actively tracking the shooting object as you pan and roll the Gimbal.
-  **TF** Tilting-Following:
Press the mode switch button to unlock Tilting-Following mode for Active Triaxial Track (Tilting-Rolling-Panning).
-  **L** Locked:
Lock the Active Triaxial Track.
-  **PV** POV (Point of View/Roll Follow Mode):
Activate the Roll Follow Mode for POV shots.

Wheel Dial: Press down the wheel dial to switch shooting motion modes:

-  **TL** Zooming:
Turn the dial to zoom in and out.
-  **TL** Focusing:
Turn the dial to focus.
-  **TL** Panning Motion:
Turn the dial to control panning.
-  **TL** Tilting Motion:
Turn the dial to adjust the tilt.

Instant App Control Button:

For instant shooting control via the App Control Button, connect the Gimbal to the SIRUI Swift APP.

To display the Option Menu, press the App Control Button. Turn the Wheel Dial to set options. Press the App Control Button to exit the menu.

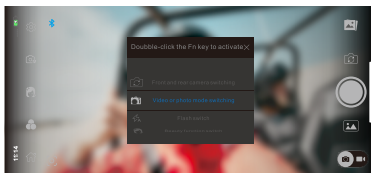

Press the Fn button twice to activate the selected option and to close the App menu page.

When the Gimbal connects with the App, the activated option will display at the bottom of the OLED UI. The following options are included:



No.	Option Description	Option Display on the OLED UI
1	Front/Rear Cam Switch	Cam SWITCH
2	Image/Video Mode Switch	Mode SWITCH
3	Flash On/Off	Flash
4	Beauty Mode On/Off	Facial
5	Beauty Filters On	Filter
6	Shooting Object Track On/Off	X - Track
7	90 Degree Panorama Shot	PAN 90
8	180 Degree Panorama Shot	PAN 180
9	360 Degree Panorama Shot	PAN 360
10	Sudoku Mode 1 Activated	Sudoku 1
11	Sudoku Mode 2 Activated	Sudoku 2
12	Hitchcock Zoom	Hitchcock
13	Timelapse Shot	Timelapse
14	Path Lapse Shot	Path TMLP
15	3×3 Ultra Wide Angle Panorama Shot	Wide Shot

Function Keys located on the back of the Gimbal handle:

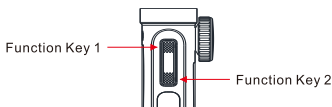

Function Key 1:

Press and hold down the upper Function Key 1 to activate the "Panning-Following" mode. Track the shooting objects actively as you pan the Gimbal and the phone quickly or proceed to move on to the next scene.

Function Key 2:

Press and hold down the lower Function Key 2 to switch between "Tilting-Following" and "Locked" modes.

Press the Function Key 2 twice to reset all axes.

Icons Displayed on the UI:



Bluetooth Connection:

This Bluetooth icon will flash when no longer connected.



Battery Level:

This battery indicator shows the current battery state and will flash when the battery level is low.



M-BLK Flash:

When blocked during use, M-BLK will flash on the OLED. To correct this, respond within 2 minutes by checking that the Gimbal Motor operation is blocked then press the Function Key 2 twice to resume operation. The Gimbal will otherwise automatically power off.



Battery Charging:

This indicates that the battery is charging while powered off.

Refer to the OLED User Interface for the charging level status.



Warning: The Gimbal will automatically power off as you plug the USB cable into the USB port to charge when the Gimbal powers on. You can cancel the Auto Power-off in the App.

Specifications of the Swift M1 Gimbal:

Product	Gimbal for Mobile Phones	Static Battery Life to Battery Runtime	6 Hours
Model	SW-M1(K)	Operating Temperature	-10°C to 45°C/ 14°F to 113°F
Folded Size	218×115×63mm/ 8.6×4.5×2.5inches	Max Load	300g/0.66lbs
Weight	498g/1.1lbs	Tilting Range	330°
Charging Voltage/Current	5V / 2A (Charge Time: 2H)	Rolling Range	160°
Battery Capacity	2500mAh	Panning Range	330°

Cautions:

1. Please avoid placing the Gimbal into fire or near hot substances or liquid.
2. Please avoid dropping or striking the product which may damage the Gimbal.
3. Please charge the Gimbal with battery chargers in accordance with safety regulations.
4. Do not attempt to disassemble, repair or modify the Gimbal as this will void the warranty.
5. Do not clean the Gimbal with cleaning products as this may damage the product.
6. Attempting to force the Gimbal movement may damage the product and void the warranty.
7. The Gimbal will not function properly when moving over the limit position.
To recover the Gimbal, position the Gimbal manually then press down the power switch to turn on the Gimbal.

WARRANTY CARD / INFORMATION

Dear SIRUI Customer,

Thank you for your purchase of SIRUI Professional Product! SIRUI warrants that your purchase is free from defects in materials and workmanship under normal use during the Limited Warranty Period. The warranty starts on the date of purchase as indicated on your original sales receipt and is non transferable. If service is required, a copy of the sales receipt must be include with a detailed explanation of the problem.

Product	Warranty Length
SIRUI Swift M1 Gimbal	1 year

Model: _____ Date: _____

Store: _____ Serial Number: _____

Warranty coverage can differ from region to region.

Please see the contact information below for product registration, information and service for the region the product was purchased in.

SIRUI 1 Year Limited Warranty of the Product (6 Months Warranty for Battery). This warranty shall be limited to repair, adjustment and/or replacement at SIRUI or its authorized distributors option, of defective parts, free of charge (except the cost of transportation to the distributor/service center). Responsibility is limited to the actual cost of the item. Call or Email with questions and service before sending any product to the center in your region. Below is a listing of contact information for Product Registration, Service Inquiries and Questions. SIRUI will not be responsible for expenses or inconveniences, or consequential damages to equipment, or by breach of any expressed or implied warranties.

※ Warranty period will vary in accordance with the local laws and regulations.

Limitations:

Warranty is non-transferable.

This warranty covers all defects encountered in normal use of the equipment and does not apply in the following cases:

1. If the equipment has been serviced by other than an authorized SIRUI Service Center.
2. Damage to the equipment caused by modification, overloading, mishandling, abuse, accident, sand*, corrosives, water damage* or by not following recommended use as instructed.
3. No valid proof of purchase is provided.
4. Damage caused by acts of nature (including, but not limited to fires, floods or earthquakes).
5. Scratches produced by normal wear and tear or damages caused by improper storage in extreme temperatures or humidity.
6. Damage related to improper use with other third party products.
7. Any attempt to access circuitry or by using non SIRUI replacement batteries.

Note: This product is intended for personal home use. This product is not intended for commercial use and will not be covered under warranty.

Warranty Address and Contact Information:

(Please contact the seller or the local distributor where the product was purchased for warranty issues or questions and before any product is sent.)

1. Guangdong SIRUI Optical Co., Ltd.

The Third Industrial District, WuguishanTown, ZhongshanCity, Guangdong, China

Tel:0086-760-88897373 Fax:0086-760-88207062

Http://www.sirui.com E-mail: info@sirui-photo.com

Service Hotline: 0086-400 830 2299

Complaint Hotline: +86-181 6563 9388

(Monday to Friday: 8:15am~12:15pm, 14:00pm~18:00pm)

2. SIRUI USA, LLC

Add: 29 Commerce Court Verona, NJ 07044

www.sirui.com

Service: Toll Free 866-373-0829 E-mail: info@sirui.com

FOR PRODUCTS PURCHASED IN THE USA PLEASE SEE:

For full details on USA Warranty Terms and Limitations:

<https://www.siruiusa.com/warranty.html>

To register products: <https://www.siruiusa.com/product-registration.html>

3. European Service Center

Add: SIRUI Optical GmbH • Ernst-Augustin-Str.1a • 12489 Berlin • Germany

Phone:+49 30 991 94 94 00 • Email: Info@siruioptical.eu

※ The company reserves the right to upgrade products and modify product specifications without prior notice. Please accept our apologies for any inconvenience we may have caused.



Patent No.:201610445963.1

使用说明

三轴手持稳定器

Swift M1



SIRUI中文官网

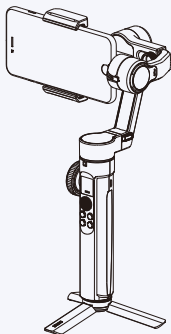

广东思锐光学股份有限公司

地址: 广东省中山市五桂山第三工业区

邮编: 528458

电话: 0760-88897373 传真: 0760-88207062

服务热线: 400 830 2299

邮箱: info@sirui-photo.com

网址: www.sirui.com

投诉电话: 18165639388

(仅限工作日 8:15~12:15, 14:00~18:00)

认识思锐Swift M1

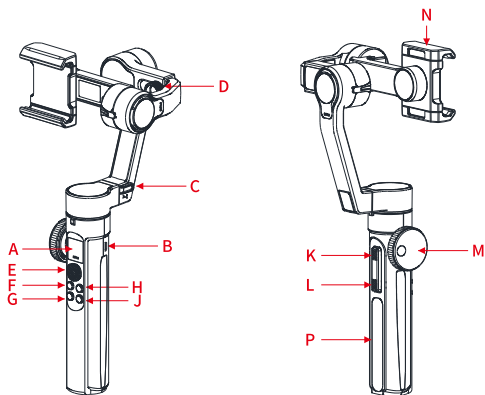

A: 液晶屏

B: USB充电口

C: 折叠板扣

D: 平衡调节旋钮

E: 四向摇杆

F: 拍摄键

G: APP快捷键

H: 模式切换键

J: 电源键

K: 功能键1

L: 功能键2

M: 滑轮键

N: 手机夹

P: 手柄

※本产品不包含手机。

物品清单：



三轴稳定器 x 1



EPP收纳包 x 1



三脚架 x 1



USB数据线 x 1



布袋 x 1

展开示意图：

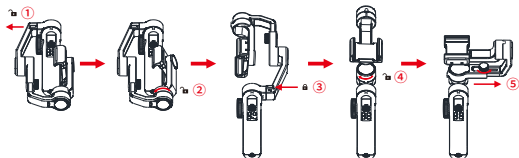

折叠示意图：

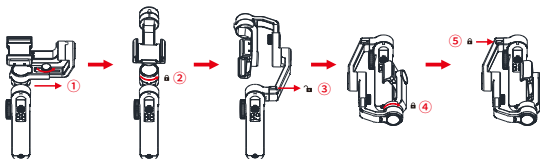

1. 下载安装SIRUI Swift App

请在手机软件商店搜索“SIRUI Swift”或使用手机扫描下方二维码安装。



⚠ SIRUI Swift 要求使用IOS 9.0及以上系统或Andriod 5.0及以上系统。

2. 充电与开启/关闭

通过手柄上的充电接口给SIRUI Swift M1充电。液晶屏会显示实时充电进度,完全充满约需1.5~2小时。



USB充电口
(5V 2A)

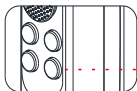

长按3秒开启
/关闭电源

3. 安装手机

⚠ 请在电源关闭的情况下安装手机以及调节平衡。

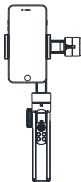
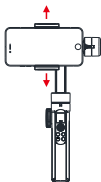

※取下手机后用力掰转手机夹即可切换横竖拍模式。

水平重心调整示意图：

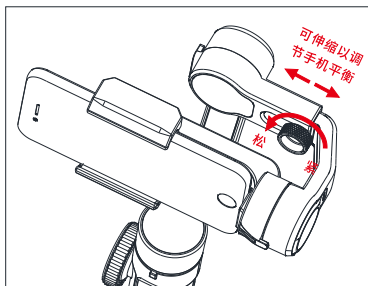

注意：如手机安装后严重不水平则可能会导致无法使用本产品。

4.连接 SIRUI Swift App



① 开启手机蓝牙功能



② 开启电源



SIRUI Swift

③ 运行SIRUI Swift App, 按提示连接SIRUI Swift M1

5.操作

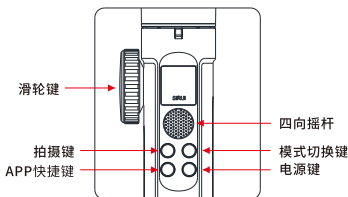

- ⦿ 电源键: 长按电源键3秒开启或关闭
- ⦿ 拍摄键: 在连接APP的状态下, 按此键可拍摄照片或开始/停止录像
- ⦿ 模式切换键: M1提供4种模式切换, 分别为,



TL模式:

此时俯仰轴锁定, 横滚轴和航向轴自动跟随模式。液晶屏上显示TL图标



TF模式:

此时俯仰轴跟随, 横滚轴和航向轴均为自动跟随。液晶屏上显示TF图标



L模式:

此时俯仰轴、横滚轴和航向轴均为锁定。液晶屏上显示L图标



PV POV模式:

此时为POV盗梦空间拍摄模式。液晶屏上显示PV图标

滑轮键: 滑轮键侧面按下, 分别提供4种模式,



放大缩小模式:

此模式下拨动滑轮, APP显示的取景图会随之放大或缩小



对焦模式:

此模式下拨动滑轮, APP显示的取景图会随之对焦



航向控制模式:

此模式下拨动滑轮, 可控制云台的航向轴左右转动



俯仰控制模式:

此模式下拨动滑轮, 可控制云台的俯仰上下操作

APP快捷键：

在连接APP的状态下此键才会有作用，操作方式如下：

单击：单击可调出APP端的控制快捷菜单，菜单出现后可拨动左侧拨轮键选择需要启动的APP功能。再次单击隐藏APP端的快捷菜单。



双击：双击则选中当前功能项并启动该功能，APP端的菜单同时也会自动退出。当下次需要直接启动该功能则可直接双击。

当APP连接后，液晶屏底部会显示当前的快捷键启动功能，快捷功能如下：



序号	自定义按键说明	液晶屏UI显示
1	前后置摄像头切换	Cam SWTCH
2	视频或拍照模式切换	Mod SWTCH
3	闪光灯开关	Flash
4	美颜功能开关	Facial
5	启动滤镜功能	Filter
6	启动或关闭对象追踪	X - Track
7	启动90度全景拍摄	PAN 90
8	启动180度全景拍摄	PAN 180
9	启动360度全景拍摄	PAN 360
10	启动九宫格拍摄-模式1	Sudoku 1
11	启动九宫格拍摄-模式2	Sudoku 2
12	启动移动变焦拍摄	Hitchcock
13	启动延时拍摄	Timelapse
14	启动轨迹延时拍摄	Path TMLP
15	启动3x3超广角全景拍摄	Wide Shot

手柄背部的功能键：

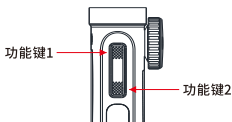

功能键1：长按功能键1进入航向快速跟随模式，在此模式下航向轴会快速跟随手的转动速度，此功能适用于转场效果拍摄

功能键2：长按功能键2不放切换俯仰模式，如当前俯仰为跟随模式则切换为锁定模式，如当前俯仰模式为锁定模式则切换为跟随模式。

双击功能键2则为一键回中，所有轴系均自动回中。

液晶屏中的状态显示：



蓝牙连接：

当蓝牙没有连接APP的时候，蓝牙图标会闪烁，连接后会停止闪烁



电量显示：

此图标显示云台的当前电量情况，当电量即将耗尽会闪烁提示



M-BLK闪烁：

在使用过程中如电机被卡住则会进入电机堵转保护(电机自动关闭)，屏幕左上角会出现M-BLK字样并闪烁，如不做任何操作，2分钟后系统会自动关机，2分钟内您也可手动排除电机卡住的情况后双击功能键2恢复电机运转。



关机充电显示：

当在关机状态下充电时，会显示充电图标并提示当前的电量



为了安全使用，如在开机状态下插入USB进行充电，则云台会自动关机。您可在APP中关闭此功能。

规格参数：

名称	三轴手持稳定器	静态续航时间	6小时
型号	SW-M1(K)	工作温度	-10℃ ~ 45℃
折叠尺寸	218x115x63mm	最大负载	300g
重量	498g	俯仰轴机械转动范围	330°
充电电压/电流	5V/2A	横滚轴机械转动范围	160°
电池容量	2500mAh	航向轴机械转动范围	330°

注意事项

- 请勿投入火中或靠近高温物体；
- 摔落或受到外力碰撞可能会使SWIFT M1损坏, 请小心使用；
- 请勿靠近液体或用液体清洗剂清洗；
- 请勿自行拆卸、修理或改装SWIFT M1；
- 请使用符合安全规定的充电器对SWIFT M1进行充电；
- 使用过程中, 请勿使用外力干扰SWIFT M1运作；
- 操作过程中, 如因触达极限位置而导致稳定器不能正常工作, 请手动扶正后, 重启稳定器方可正常使用。

保修卡

尊敬的顾客：

感谢您购买思锐的产品！在正常使用过程中, 如果因产品本身的材料及工艺出现质量问题, 思锐将会提供免费的保修服务。在需要保修服务时, 请提供本保修卡和购买凭证(收据或发票, 须有商家盖章), 思锐公司售后服务热线: 400 830 2299

产品名称	保修期限
三轴手持稳定器	1年

产品型号： _____ 购买日期： _____

商店名称： _____ 商店电话： _____

商店地址： _____

商店盖章： _____

顾客须知：

(1)产品保修1年, 电池保修6个月, 保修时间从购买之日起算。

(2)所保修的产品, 必须是在思锐正式授权的经销商或电子商务处所购买, 申请保修服务时需提供保修卡和销售证明(收据或发票, 须有商家盖章)。

(3)需寄回思锐工厂维修的, 请先拨打思锐服务电话, 待确认故障后, 思锐公司承担来回运费。一般性故障可在7个工作日内完成维修并寄回。

(4)保修范围不包括以下情形：

- ①超过保修期限的；
- ②在非思锐正式授权经销商处购买的；
- ③在非思锐授权的代理商或维修中心维修过的；
- ④由于不正当操作、意外事件、自然灾害导致的故障或损伤。
- ⑤外观损坏,包括但不限于刮痕、凹痕。
- ⑥使用第三方组件或产品而造成的损坏。
- ⑦因非官方说明书指导的电路改造、或电池组、充电器的匹配使用不当导致的损坏。

(5)退换货政策请登录www.sirui.com了解,或咨询当地经销商。

注:本产品仅适用于普通终端用户及家庭使用,任何商业目的或商业方式使用本产品,均不属于本质保范围。

维修登记表

用户姓名	
用户电话	
用户地址	
邮编	
故障维修描述	
维修人员签名	
维修时间	

思锐公司保留产品升级和由于产品升级而变更各参数的权利,请以实物为准,恕不另行通知。印刷品上如有印刷错误或语词方面的错漏如造成不便,敬请包涵。